

Application

Suitable for interior and exterior top hung sliding doors.

Ideal for sliding doors and shutters in residential and commercial applications.

Versatile design allows the opening to be covered by any number of doors.

The aluminium track maybe fitted directly to the lintel, in single or multiple lines, or face fitted to the lintel using a single line of brackets.

Hangers come standard with a steel bracket and four nylon tyred wheels with precision bearings. A choice of stainless or chrome bearings is available to suit the application.

Door Specification

Track System:	Single Run 60
For Individual Doors:	
Max Door Weight	60kg
Max Door Height	2400mm
Min Door Thickness	19mm

Standard Sets and Packs

Single Run 60 sets, each suitable for sliding one door, comprising of aluminium track, brackets, two 605 hangers, two door stops, one guide, spanner and screws.

Set No.	Door Widths	Track Width	Qty Brackets
SR60-20/1	610mm to 915mm	2000mm	5
SR60-30/1	915mm to 1525mm	3000mm	10

Pack No.

SR60-1PK Single Run 60 door pack, each suitable for sliding one door, comprising of two hangers, two door stops, one guide, spanner and screws.

Hardware Specification

Track - punched for soft fitting:	60
Material	Aluminium
Standard lengths	2000mm (8)
(Max quantity of brackets, required)	3000mm (12)
	4000mm (15)
	6000mm (23)

Brackets:

Single	91
Pack of 5 brackets	91/5
Bracket 91 made from stainless steel. Supplied with matching fasteners.	

Hangers (2 per door):

605

The 605 hanger has a nylon body and comes standard with zinc plated steel bracket and four nylon tyred wheels with chrome precision bearings.

Hanger (2 per door):

604SS

The 604SS hanger has a stainless steel body and comes standard with stainless steel bracket and four nylon tyred wheels with stainless steel precision bearings.

Door Stops:

287S

Door stop 287S is made from stainless steel. Supplied with a rubber buffer and locking screw.

Guide:

55G

Guide in white nylon, comes in two parts that fit on both sides of the door. The guide is floor mounted.

Spanner:

Pressed steel zinc plated.	805-SPN	to suit 605 Hanger
	H366SP	to suit 604SS Hanger

Accessories:

Alternative Guide 801
Spring loaded guide, nylon body and tip with zinc plated steel shaft. Designed to slide in the 92 and 130 thresholds.

Alternative Guide

801S

Spring loaded guide, nylon body and stainless steel shaft. Designed to slide in the 92 threshold and 81 channel. For exterior applications.

Alternative Guide

101N

The nylon guide is designed to slide through a 20mm deep by 5mm wide sawcut in the bottom rail of the door.

Cavity Guide

C155LS

Nylon guide for cavity door applications.

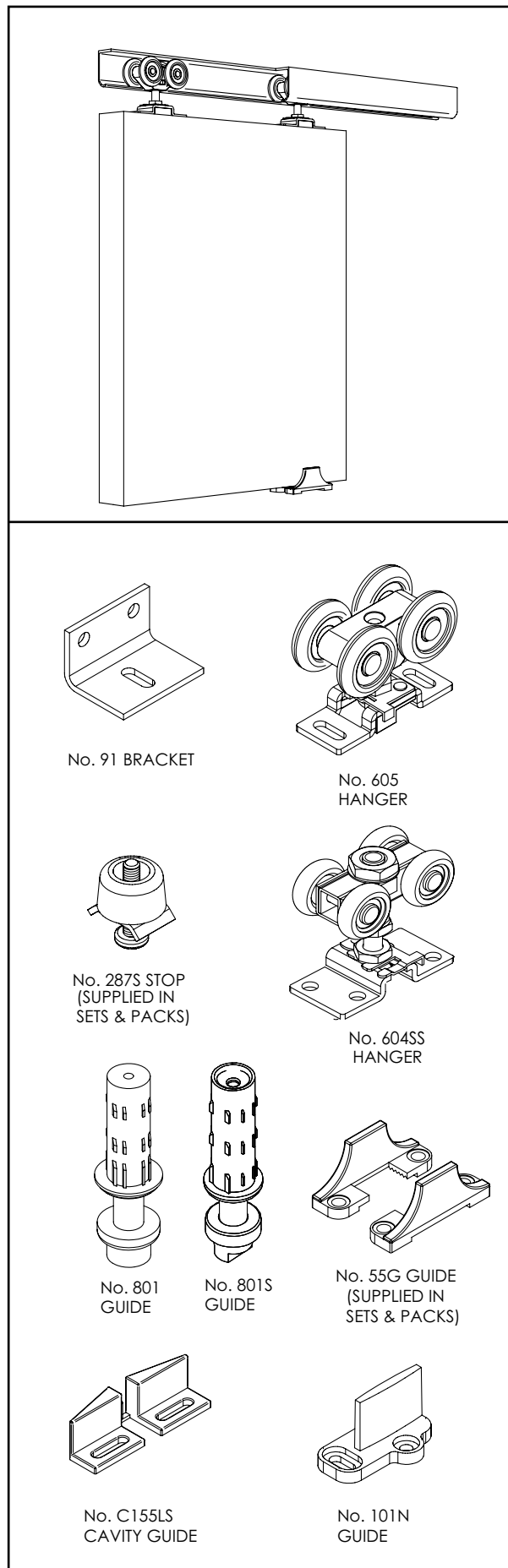

INSTALLATION INSTRUCTIONS

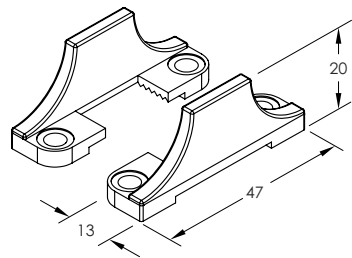
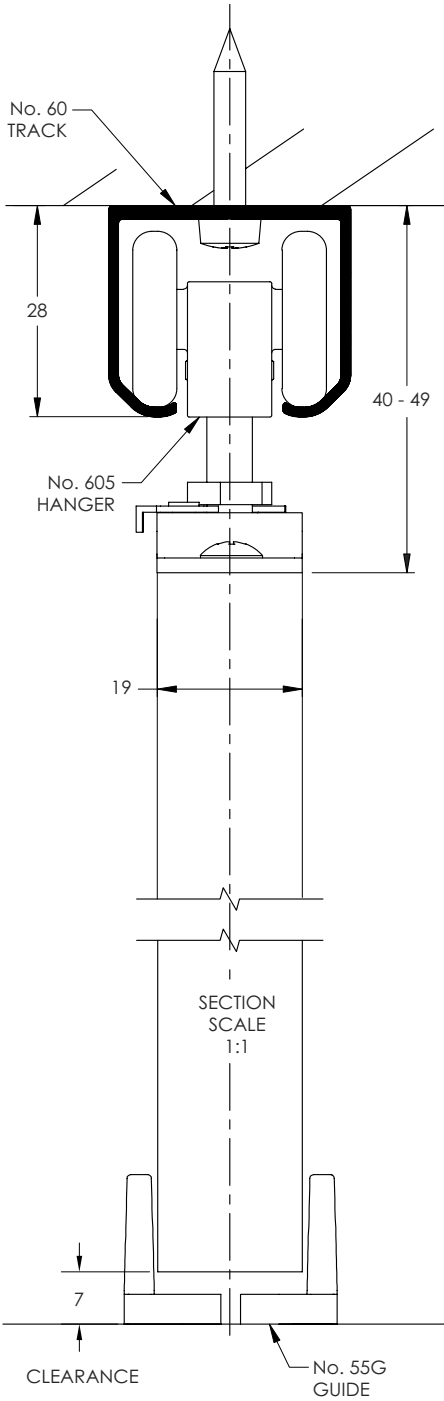

No. 55G GUIDE INCLUDED IN SETS & FITTING PACKS. SUITABLE FOR DOORS OF ANY WIDTH

1 Prepare Hardware

Screw hanger bolts into hangers and Door Stops.
Insert hangers into track. Insert a door stop at either end to retain hangers during track installation.

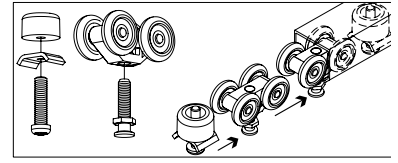

2 Attach Hardware to Door

Hanger Mounting Plates should be positioned centrally in the door width. Plates should be facing the same direction. Opening facing cavity opening.

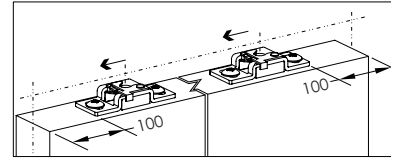

3 Fix Track Parallel to Floor

Soffit Fix- Position 8g screws first 50mm in from each end and every 300mm between.
Face Fix- Use 91 brackets.

Track Length	900	1250	1700	2100	2500	3000	3805	5105	6000
Bracket Qty.	4	5	7	8	10	12	15	19	23

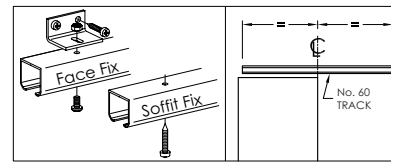

4 Hang Door

With the latch on the Mounting Plates open. Bring door up to hangers and push hanger bolt into Plate. Close latches when bolts are in the plates.

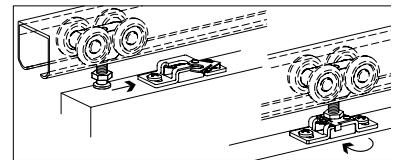

5 Adjust Door

Screw bolt in or out of Hanger to adjust door height. Adjust door height so door is square.

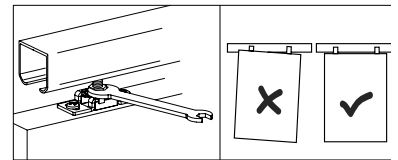

6 Fit Door Guide

Locate at opening jamb. With door hanging plumb fix guides to either side of door.

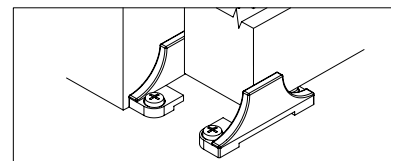

7 Position Door Stops

Fit one stop to each end of the Track where required. Loosen screw to move and tighten to fix in position.

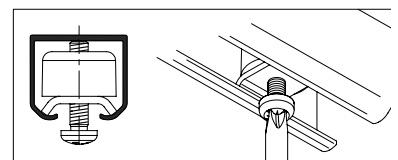

ALTERNATIVE GUIDE SYSTEMS

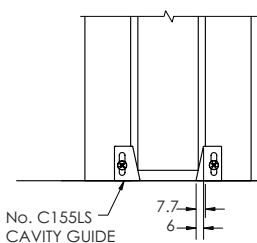

No. C155LS CAVITY GUIDE

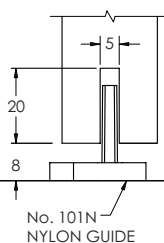

No. 101N NYLON GUIDE

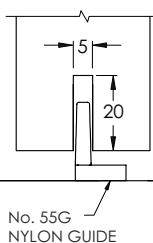

No. 55G NYLON GUIDE

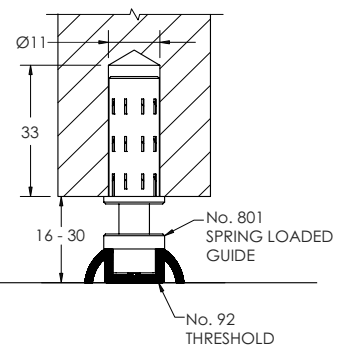

No. 801 SPRING LOADED GUIDE
No. 92 THRESHOLD