

# Sliding & Folding Solutions

## **Straight sliding top hung**

- S03 Brio Sprintline 30
- S04 Brio Wardrobe Single 50
- S05 Brio Wardrobe Double 50
- S06 Brio Single Run 60
- S07 Brio Quick Run 120
- S09 Brio Single Run Exterior 120
- S10 Brio Single Run 180
- S11 Brio Single Run 350
- S12 Brio Simultaneous and Telescopic
- S13 Brio Zero Clearance 60
- S14 Brio Zero Clearance 180 and 350
- S15 Brio Open Round Rail Glass 100
- S16 Brio Open Bar Rail Timber 80
- S17 Brio Open Round Rail Timber 100
- S18 Brio Open Square Rail Timber 150

## **Straight sliding bottom rolling**

- S19 Brio Wardrobe Roll 50
- S20 Brio Wardrobe Roll Trio 50
- S21 Brio Timberoll
- S22 Brio Guide channels and accessories

## **Interior folding**

- S24 Brio Multifold 30
- S25 Brio Pivotfold 35 and 75
- S25 Brio Centrefold 35 and 75
- S25 Brio Endfold 35 and 75
- S26 Brio Interfold 35F and 50F
- S27 Brio Interfold 35 and 50
- S28 Brio Guide channels, hinges and accessories

## **Exterior folding**

- S29 Brio Weatherfold 4s Servery 35
- S30 Brio Weatherfold 4s Window 35
- S31 Brio Weatherfold 4s 50 and 100 - non-mortice hinges
- S33 Brio Weatherfold 4s 50 and 100 - square mortice hinges
- S35 Brio Weatherfold 4s 150
- S36 Brio Weatherfold 4s accessories

## **Flush bolts and locking solutions**

- S37 Brio Flush bolts
- S38 Brio 286 Dual point lock

## **Retractable insect screens**

- S39 Brio 612 Retractable insect screens

# Finish glossary

These colours are indicative only, subject to limitations in the printing process.



**ABZ**

Antique Bronze



**ANOD**

Anodised Aluminium

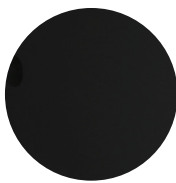

**BLACK**

Black Powder Coat



**PB**

Polished Brass



**PVD BLACK**

PVD Black



**SNP**

Satin Nickel Plate



**SSS**

Satin Stainless Steel



**WHITE**

White Powder Coat

# Warranties

Brio Sliding and Folding Door Hardware	10 years mechanical	<a href="http://allegion.co.nz/finisheswarranty">allegion.co.nz/finisheswarranty</a>
Brio 612 Retractable Insect Screens (interior)	5 years mechanical	<a href="http://allegion.co.nz/finisheswarranty">allegion.co.nz/finisheswarranty</a>
Brio 612 Retractable Insect Screens (exterior)	1 year mechanical	<a href="http://allegion.co.nz/finisheswarranty">allegion.co.nz/finisheswarranty</a>

# Brio Sprintline 30

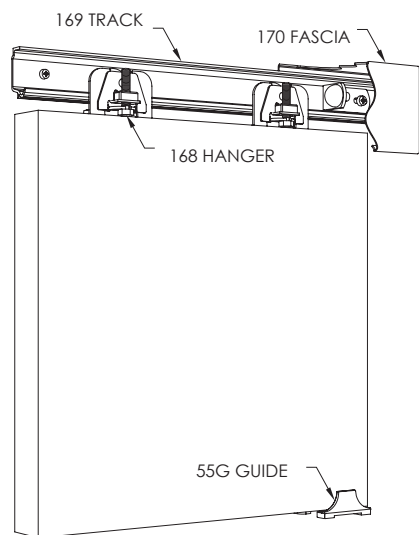

Maximum door weight	30kg
Minimum door thickness	25mm

Sets - includes track and fittings for one door

Description	Code	Price
Kit suitable to hang one door, comprising: 1.6m length of aluminium track, two door hangers, two track mounted door stops, one sawcut guide, one surface mounted guide, all screws and installation instructions.	SL30-16/1	74.50
Kit suitable to hang one door, comprising: 2.4m length of aluminium track, two door hangers, two track mounted door stops, one sawcut guide, one surface mounted guide, all screws and installation instructions.	SL30-24/1	89.50

## Fittings pack

Description	Code	Price
Fittings pack with all items needed to hang one door (excluding track), pack comprises two door hangers, two track mounted door stops, one sawcut guide, one surface mounted guide, all screws and installation instructions.	SL30-1PK	44.50

## Components

Description	Code	Price
1.6m Sprintline 30 track	169-16	30.50
2.4m Sprintline 30 track	169-24	47.50
Track mounted door stop - steel with rubber buffer	263	10.00
Wall mounted door stop - nylon	28N	7.50
Floor mounted surface guide - nylon	55G	5.00
Sprintline door hanger	168	15.50
Sawcut guide - nylon - floor mounted	101N	5.30

## Optional fascia

Description	Code	Price
1.8m hook-on aluminium fascia in pearl white finish includes end caps	170-18	108.00
3m hook-on aluminium fascia in pearl white finish includes end caps	170-30	233.00

## Alternative door guide systems

Description	Code	Price
Stainless steel sawcut guide	531T	38.00
92 Series spring loaded guide - stainless steel	801S	14.50
4m 92 Series threshold guide channel - aluminium - anodised finish	92-A40	156.00
6m 92 Series threshold guide channel - aluminium - anodised finish	92-A60	210.00

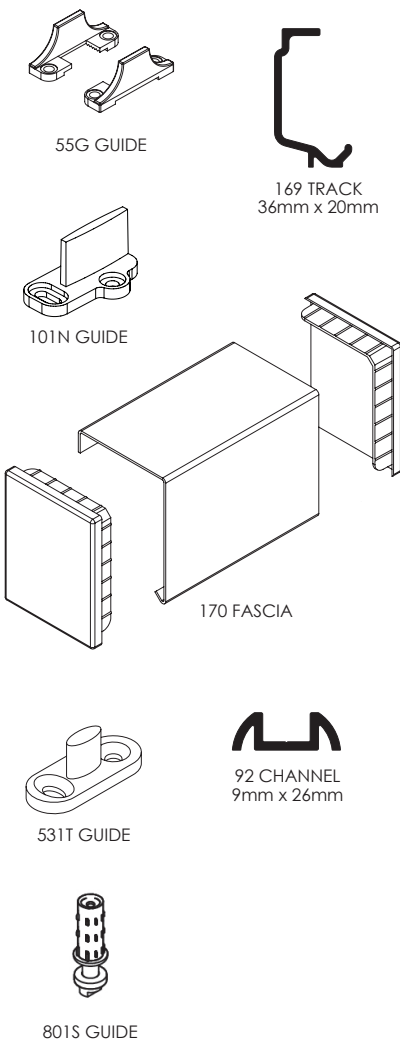

# Brio Wardrobe Single 50

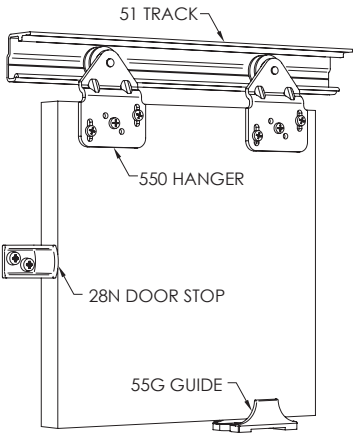

Maximum door weight	50kg
Minimum door thickness	16mm

Sets - includes track and fittings for one door

Description	Code	Price
Kit suitable to hang one door, comprising: 1.2m length of aluminium track, two door hangers, two door stops, one sawcut guide, one surface mounted guide, all screws and installation instructions.	WS50-12/1	61.50
Kit suitable to hang one door, comprising: 1.5m length of aluminium track, two door hangers, two door stops, one sawcut guide, one surface mounted guide, all screws and installation instructions.	WS50-15/1	70.50
Kit suitable to hang one door, comprising: 1.8m length of aluminium track, two door hangers, two door stops, one sawcut guide, one surface mounted guide, all screws and installation instructions.	WS50-18/1	83.50

## Fittings pack

Description	Code	Price
Fittings pack with all items needed to hang one door (excluding track), pack comprises of two reversible door hangers, two wall mounted door stops, one sawcut guide, one surface mounted guide, all screws and installation instructions.	WS50-1PK	41.50

## Components

Description	Code	Price
1.2m Wardrobe Single 50 track	51-12	23.50
1.5m Wardrobe Single 50 track	51-15	30.50
1.8m Wardrobe Single 50 track	51-18	43.00
2.4m Wardrobe Single 50 track	51-24	57.00
3m Wardrobe Single 50 track	51-30	71.50
3.6m Wardrobe Single 50 track	51-36	85.50
4.8m Wardrobe Single 50 track	51-48	95.00
Wardrobe Single / Double 50 – Outer hanger	550	12.50
Wardrobe Single / Double 50 – Reversible hanger	552	14.00
Wall mounted door stop – nylon	28N	7.50
Floor mounted surface guide – nylon	55G	5.00
Sawcut guide – nylon – floor mounted	101N	5.30

## Optional fascia

Description	Code	Price
1.8m hook-on aluminium fascia in pearl white finish includes end caps	170-18	108.00
3m hook-on aluminium fascia in pearl white finish includes end caps	170-30	233.00

## Alternative door guide systems

Description	Code	Price
Stainless steel sawcut guide	531T	38.00
92 Series spring loaded guide – stainless steel	801S	14.50
4m 92 Series threshold guide channel – aluminium – anodised finish	92-A40	156.00
6m 92 Series threshold guide channel – aluminium – anodised finish	92-A60	210.00



51 TRACK  
28mm x 29mm

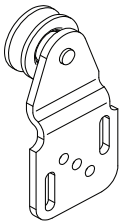

550 HANGER

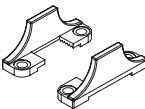

55G GUIDE

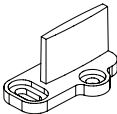

101N GUIDE

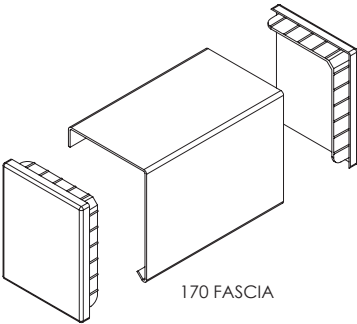

170 FASCIA

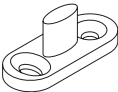

531T GUIDE



92 CHANNEL  
9mm x 26mm



801S GUIDE



# Brio Wardrobe Double 50

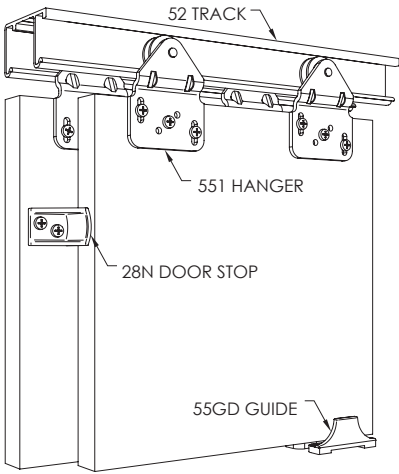

Maximum door weight	50kg
Minimum door thickness	16mm

Sets - include track and fittings for two or three doors

Description	Code	Price
Kit suitable for two doors, comprising: 1.2m length of double run aluminium track, two inner hangers, two outer hangers, two door stops, one double surface mounted guide, two sawcut guides, all screws and installation instructions.	WD50-12/2	103.00
Kit suitable for two doors, comprising: 1.5m length of double run aluminium track, two inner hangers, two outer hangers, two door stops, one double surface mounted guide, two sawcut guides, all screws and installation instructions.	WD50-15/2	109.00
Kit suitable for two doors, comprising: 1.8m length of double run aluminium track, two inner hangers, two outer hangers, two door stops, one double surface mounted guide, two sawcut guides, all screws and installation instructions.	WD50-18/2	121.00
Kit suitable for three doors, comprising: 2.4m length of double run aluminium track, two inner hangers, two outer hangers, two reversible hangers, two door stops, two double surface mounted guides, three sawcut guides, all screws and installation instructions.	WD50-24/3	161.00

## Fittings pack

Description	Code	Price
Fittings pack with all items needed to hang two doors (excluding track), pack comprises two inner door hangers, two outer door hangers, one door stop, two sawcut guides, one surface mounted double guide, all screws and installation instructions.	WD50-2PK	62.50

## Components

Description	Code	Price
1.2m Wardrobe Double 50 track	52-12	46.00
1.5m Wardrobe Double 50 track	52-15	57.00
1.8m Wardrobe Double 50 track	52-18	69.00
2.4m Wardrobe Double 50 track	52-24	93.00
3m Wardrobe Double 50 track	52-30	117.00
3.6m Wardrobe Double 50 track	52-36	141.00
4.8m Wardrobe Double 50 track	52-48	155.00
Wall mounted nylon door stop	28N	7.50
Floor mounted nylon surface guide for bi-passing doors	55GD	8.60
Wardrobe Single / Double 50 - Outer hanger	550	12.50
Wardrobe Double 50 - Inner hanger	551	12.50
Wardrobe Single / Double 50 - Reversible hanger	552	14.00
Sawcut guide - nylon - floor mounted	101N	5.30

## Alternative door guide systems

Description	Code	Price
Stainless steel sawcut guide	531T	38.00
92 Series spring loaded guide	801S	14.50
4m 92 Series threshold guide channel - aluminium - anodised finish	92-A40	156.00
6m 92 Series threshold guide channel - aluminium - anodised finish	92-A60	210.00
Door collector kit	924-DC	21.50

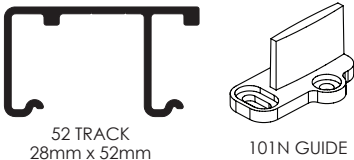

52 TRACK  
28mm x 52mm

101N GUIDE

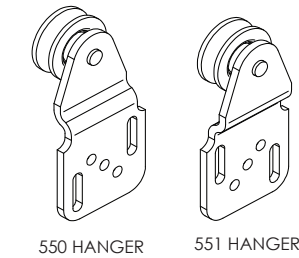

550 HANGER

551 HANGER

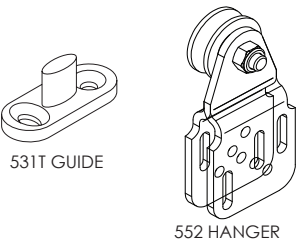

531T GUIDE

552 HANGER

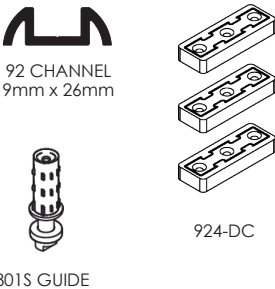

92 CHANNEL  
9mm x 26mm

801S GUIDE

924-DC

# Brio Single Run 60

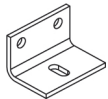
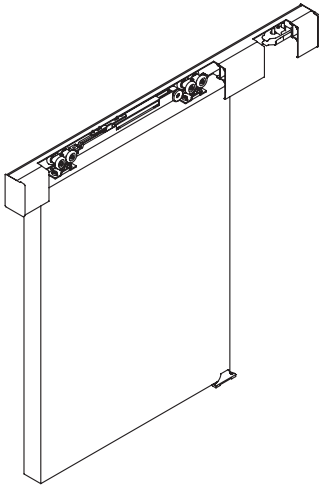

91Z BRACKET

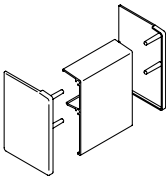

63 FASCIA



60A TRACK  
31mm x 30mm

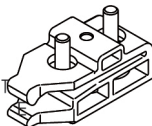

60CS CLIP STOP

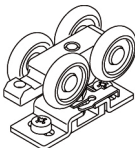

607 HANGER

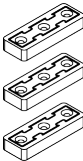

924-DC

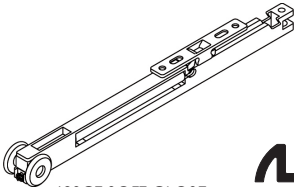

60SCT SOFT CLOSE



92 CHANNEL  
9mm x 26mm



101N GUIDE



801S GUIDE

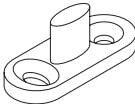

531T GUIDE

Maximum door weight	60kg
Minimum door thickness	19mm

Sets - includes track and fittings for one door

Description	Code	Price
Kit suitable for one door, kit comprises: 2m length of aluminium track, five wall mounting brackets, two door hangers, two track mounted door stops, one surface mounted guide, one sawcut guide, spanner, all screws and installation instructions.	SR60-20/1	171.00
Kit suitable for one door, kit comprises: 3m length of aluminium track, five wall mounting brackets, two door hangers, two track mounted door stops, one surface mounted guide, one sawcut guide, spanner, all screws and installation instructions.	SR60-30/1	256.00

## Fittings pack

Description	Code	Price
Fittings pack with all items needed to hang one door (excluding track), pack comprises of two hangers, two door stops, one surface mounted guide, one sawcut guide, spanner, all screws and installation instructions.	SR60-1PK	98.50

## Track brackets - for wall fixing track

Description	Code	Price
Single with fasteners	91Z	8.10
Five pack with fasteners	91Z/5	37.00

## Fascia

Description	Code	Price
2m Fascia and end cap set for Single Run 60 - powder coated white	63-20PWT	116.00
3m Fascia and end cap set for Single Run 60 - powder coated white	63-30PWT	174.00
2m Fascia and end cap set for Single Run 60 - anodised	63-20CA	116.00
3m Fascia and end cap set for Single Run 60 - anodised	63-30CA	174.00

## Components

Description	Code	Price
2m aluminium track - mill finish	60A-20	53.00
3m aluminium track - mill finish	60A-30	78.50
4m aluminium track - mill finish	60A-40	101.00
6m aluminium track - mill finish	60A-60	131.00
Single Run 60 Door Hanger	607	34.50
Track mounted retaining clip stop	60CS	16.50
Soft close unit	60SCT	71.50
Sawcut guide - nylon - floor mounted	101N	5.30
Spanner for 605 and 606 hanger	805-SPN	6.10
4m 92 Series threshold guide channel - aluminium - anodised finish	92-A40	156.00
6m 92 Series threshold guide channel - aluminium - anodised finish	92-A60	210.00
Stainless steel sawcut guide	531T	38.00
81 or 92 Series spring loaded guide - stainless steel	801S	14.50
Door collector kit	924-DC	21.50

# Brio Quick Run 120

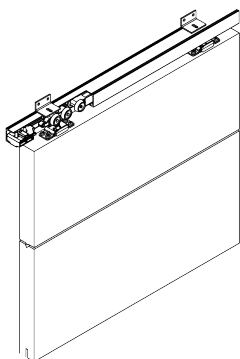

Maximum door weight	120kg
Minimum door thickness (surface mount, recessed mount door hangers)	28mm
Minimum door thickness (zero clearance door hangers)	32mm

## Fitting packs

Description	Code	Price
Quick Run 120 1 Door fittings pack – surface mount door hangers Comprises two surface mount door hangers, two clip stops, one saw cut guide	QR120S-C1PK	185.00
Quick Run 120 1 Door fittings pack – recessed mount door hangers Comprises two recessed mount door hangers, two clip stops, one saw cut guide	QR120R-C1PK	205.00
Quick Run 120 1 Door fittings pack – zero clearance door hangers Comprises two zero clearance door hangers, two clip stops, one saw cut guide	QR120Z-C1PK	390.00

## Kit sets with surface mount door hangers (to hang one door)

Description	Code	Price
Quick Run 120F 2m kit set with surface mount door hangers and clip stops Comprises 2m 120F track, two surface mount door hangers, two clip stops, one saw cut guide	QR120S-C20F/1	240.00
Quick Run 120F 3m kit set with surface mount door hangers and clip stops Comprises 3m 120F track, two surface mount door hangers, two clip stops, one saw cut guide	QR120S-C30F/1	265.00
Quick Run 120F 2m kit set with surface mount door hanger and soft close Comprises 2m 120F track, two surface mount door hangers, two soft close units, one saw cut guide	QR120S-S20F/1	490.00
Quick Run 120F 3m kit set with surface mount door hangers and soft close Comprises 3m 120F track, two surface mount door hangers, two soft close units, one saw cut guide	QR120S-S30F/1	515.00

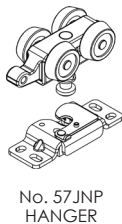

No. 57JNP  
HANGER

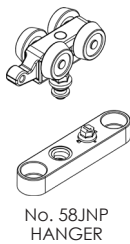

No. 58JNP  
HANGER

## Kit sets with recessed mount door hangers (to hang one door)

Description	Code	Price
Quick Run 120F 2m kit set with recessed mount door hangers and clip stops Comprises 2m 120F track, two recessed mount door hangers, two clip stops, one saw cut guide	QR120R-C20F/1	260.00
Quick Run 120F 3m kit set with recessed mount door hangers and clip stops Comprises 3m 120F track, two recessed mount door hangers, two clip stops, one saw cut guide	QR120R-C30F/1	290.00
Quick Run 120F 2m kit set with recessed mount door hangers and soft close Comprises 2m 120F track, two recessed mount door hangers, two soft close units, one saw cut guide	QR120R-S20F/1	510.00
Quick Run 120F 3m kit set with recessed mount door hangers and soft close Comprises 3m 120F track, two recessed mount door hangers, two soft close units, one saw cut guide	QR120R-S30F/1	540.00

## Kit sets with zero clearance door hangers (to hang one door)

Description	Code	Price
Quick Run 120F 2m kit set with zero clearance door hangers and clip stops Comprises 2m 120F track, two zero clearance door hangers, two clip stops, one saw cut guide	QR120Z-C20F/1	445.00
Quick Run 120F 3m kit set with zero clearance door hangers and clip stops Comprises 3m 120F track, two zero clearance door hangers, two clip stops, one saw cut guide	QR120Z-C30F/1	470.00
Quick Run 120C 2m kit set with zero clearance door hangers and clip stops Comprises 2m 120C track, two zero clearance door hangers, two clip stops, one saw cut guide	QR120Z-C20C/1	460.00
Quick Run 120C 3m kit set with zero clearance door hangers and clip stops Comprises 3m 120C track, two zero clearance door hangers, two clip stops, one saw cut guide	QR120Z-C30C/1	490.00
Quick Run 120F 2m kit set with zero clearance door hangers and soft close Comprises 2m 120F track, two zero clearance door hangers, two soft close units, one saw cut guide	QR120Z-S20F/1	700.00
Quick Run 120F 3m kit set with zero clearance door hangers and soft close Comprises 3m 120F track, two zero clearance door hangers, two soft close units, one saw cut guide	QR120Z-S30F/1	725.00
Quick Run 120C 2m kit set with zero clearance door hangers and soft close Comprises 2m 120C track, two zero clearance door hangers, two soft close units, one saw cut guide	QR120Z-S20C/1	710.00
Quick Run 120C 3m kit set with zero clearance door hangers and soft close Comprises 3m 120C track, two zero clearance door hangers, two soft close units, one saw cut guide	QR120Z-S30C/1	740.00

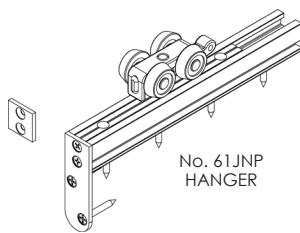

No. 61JNP  
HANGER

## Door hanger sets

Description	Code	Price
Surface mount door hanger set (pair) with quick fix surface mount top plates	57JNP	130.00
Recessed mount door hanger set (pair) with quick fix recessed mount top plates	58JNP	155.00
Zero clearance door hanger set (pair)	61JNP	155.00

## Door stops and accessories

Description	Code	Price
Track mounted door stop for Quick Run 120 / Quick Run Zero Clearance 120 door hangers	120CS	35.00
Soft close kit for Quick Run 120 / Quick Run Zero Clearance 120	120SCT	175.00
Door collector kit	924-DC	21.50

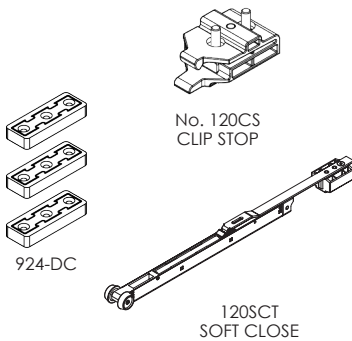

No. 120CS  
CLIP STOP

120SCT  
SOFT CLOSE

# Brio Quick Run 120

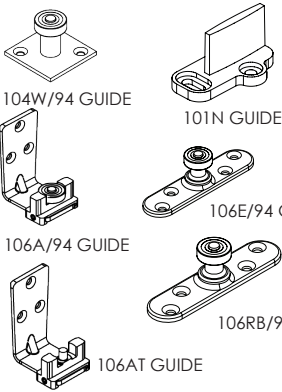

120F TRACK



120C TRACK



120E TRACK

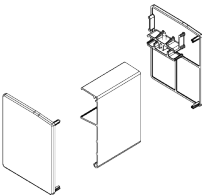

123 FASCIA



91Z BRACKET



1SS/250 BRACKET



5SS/120 BRACKET

## Guides

Description	Code	Price
Sawcut guide - nylon - floor mounted	101N	5.30
Stainless steel sawcut guide	531T	38.00
Adjustable guide for multiple panels	106AT	47.50
94 Series guide - stainless steel plate and precision bearing	106E/94	59.50
94 Series guide - large stainless steel mounting plate and precision bearing	106RB/94	78.00
94 Series guide - square mounting plate	104W/94PR	33.50
94 Series guide - stainless steel angle plate with adjustable precision bearing	106A/94	61.50

## Standard Track (Type F)

Description	Code	Price
2m aluminium - clear anodised finish	120F-A20	60.00
3m aluminium - clear anodised finish	120F-A30	90.00
4m aluminium - clear anodised finish	120F-A40	120.00
6m aluminium - clear anodised finish	120F-A60	175.00

## Tracks suitable for recessing into the ceiling (Type C)

Description	Code	Price
2m aluminium - clear anodised finish	120C-A20	75.00
3m aluminium - clear anodised finish	120C-A30	110.00
4m aluminium - clear anodised finish	120C-A40	145.00
6m aluminium - clear anodised finish	120C-A60	210.00

## Tracks for use with 123 fascia (Type E)

Description	Code	Price
2m aluminium - clear anodised finish	120E-A20	75.00
3m aluminium - clear anodised finish	120E-A30	110.00
4m aluminium - clear anodised finish	120E-A40	145.00
6m aluminium - clear anodised finish	120E-A60	210.00

## Fascia for 120E track only

Description	Code	Price
2m aluminium - clear anodised finish	123-20CA	99.00
3m aluminium - clear anodised finish	123-30CA	149.00
4m aluminium - clear anodised finish	123-40CA	193.00
6m aluminium - clear anodised finish	123-60CA	287.00

## Track brackets - for wall fixing track

Description	Code	Price
Single with fasteners	91Z	8.10
Five pack with fasteners	91Z/5	37.00
Heavy duty bracket - cast stainless steel	1SS/250	47.00
Bracket for hanging two lines of track - cast stainless steel	5SS/120	85.50

# Brio Single Run Exterior 120

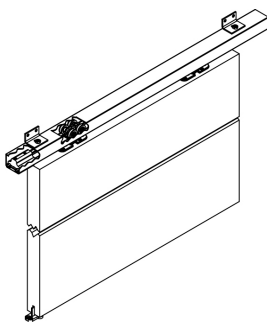

Maximum door weight	120kg
Minimum door thickness	28mm

Sets - includes track and fittings for one door

Description	Code	Price
Kit suitable for one door, kit comprises: 2m length of aluminium track, two standard door hangers, two track mounted door stops, one sawcut guide and installation instructions.	SR120SS-20/1	550.00
Kit suitable for one door, kit comprises: 3m length of aluminium track, two standard door hangers, two track mounted door stops, one sawcut guide and installation instructions.	SR120SS-30/1	620.00



120A TRACK  
30mm x 41mm

## Fittings pack

Description	Code	Price
Fittings pack with all items needed to hang one door (excluding track), pack comprises of two standard door hangers, two door stops, one sawcut guide and installation instructions.	SR120SS-1PK	404.00

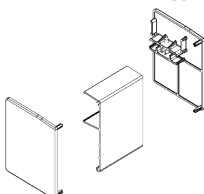

123 FASCIA



1SS/250 BRACKET

## Tracks

Description	Code	Price
2m aluminium - anodised finish	120A-A20	69.00
3m aluminium - anodised finish	120A-A30	105.00
4m aluminium - anodised finish	120A-A40	124.00
6m aluminium - anodised finish	120A-A60	189.00

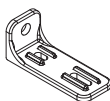

5SS/120 BRACKET

## Fascia

Description	Code	Price
2m Fascia and end cap set for 120A Track - anodised finish	123-20CA	99.00
3m Fascia and end cap set for 120A Track - anodised finish	123-30CA	149.00
4m Fascia and end cap set for 120A Track - anodised finish	123-40CA	193.00
6m Fascia and end cap set for 120A Track - anodised finish	123-60CA	287.00

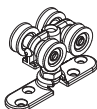

57SS/EN HANGER

## Track brackets - for wall fixing track

Description	Code	Price
Heavy duty bracket - cast stainless steel	1SS/250	47.00
Bracket for hanging two lines of track - cast stainless steel	5SS/120	85.50

## Door hangers (always use two per door)

Description	Code	Price
Type 57 - surface mounted pressed top plate with nylon wheels and stainless steel bearings	57SS/EN	188.00

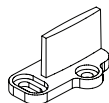

101N GUIDE

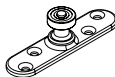

106E/94 GUIDE

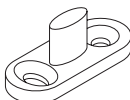

531T GUIDE

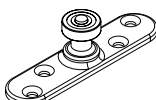

106RB/94 GUIDE

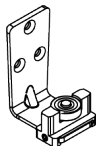

106A/94 GUIDE

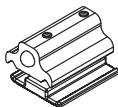

120DS DOOR STOP

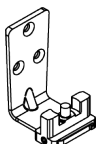

106AT GUIDE

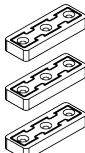

924-DC

## Guides

Description	Code	Price
Sawcut guide - nylon - floor mounted	101N	5.30
Stainless steel sawcut guide	531T	38.00
Adjustable guide for multiple panels	106AT	47.50
94 Series guide - stainless steel plate and precision bearing	106E/94	59.50
94 Series guide - large stainless steel mounting plate and precision bearing	106RB/94	78.00
94 Series guide - stainless steel angle plate with adjustable precision bearing	106A/94	61.50

## Door stops and accessories

Description	Code	Price
Track mounted door stop for Single Run 80 or Single Run 120	120DS	48.50
Door collector kit	924-DC	21.50

# Brio Single Run 180

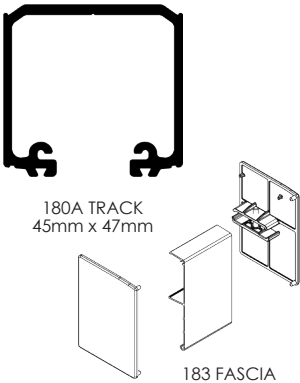

180A TRACK  
45mm x 47mm

183 FASCIA



1SS/250 BRACKET



5SS/250 BRACKET

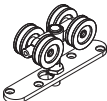

57GN HANGER

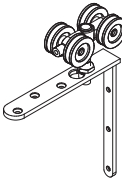

52GN HANGER



56GN HANGER

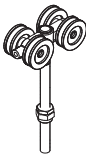

56GLN HANGER

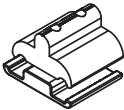

180DS DOOR STOP

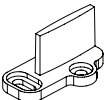

101N GUIDE

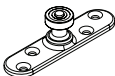

106E/94 GUIDE

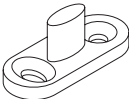

531T GUIDE

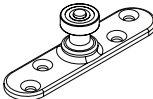

106RB/94 GUIDE

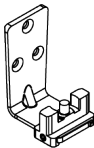

106AT GUIDE

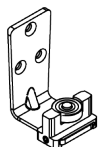

106A/94 GUIDE



94PPA CHANNEL  
23mm x 25mm



94P CHANNEL  
20mm x 20mm

Maximum door weight	180kg
Minimum door thickness	35mm

## Tracks

Description	Code	Price
2m aluminium – anodised finish	180A-A20	149.00
2.5m aluminium – anodised finish	180A-A25	197.00
3m aluminium – anodised finish	180A-A30	227.00
4m aluminium – anodised finish	180A-A40	300.00
5m aluminium – anodised finish	180A-A50	370.00
6m aluminium – anodised finish	180A-A60	446.00

## Fascia

Description	Code	Price
2m Fascia and end cap set for 180A Track – anodised finish	183-20CA	164.00
3m Fascia and end cap set for 180A Track – anodised finish	183-30CA	224.00
4m Fascia and end cap set for 180A Track – anodised finish	183-40CA	273.00
6m Fascia and end cap set for 180A Track – anodised finish	183-60CA	376.00

## Track brackets - for wall fixing track

Description	Code	Price
Heavy duty bracket – cast stainless steel	1SS/250	47.00
Heavy duty bracket for hanging two lines of track – cast stainless steel	5SS/250	146.00

## Door hangers - for timber doors (always use two per door)

Description	Code	Price
Type 52 – corner fixing plate with chrome steel bearings	52GN	239.00
Type 52 – corner fixing plate with stainless steel bearings	52SS/GN	326.00
Type 57 – top fixing plate with chrome steel bearings	57GN	212.00
Type 57 – top fixing plate with stainless steel bearings	57SS/GN	353.00

## Door hangers - for metal doors (always use two per door)

Description	Code	Price
Type 56 – short bolt fix	56GN	152.00
Type 56L – long bolt fix	56GLN	166.00

## Door stop

Description	Code	Price
Track mounted door stop	180DS	59.00

## Guides

Description	Code	Price
Stainless steel sawcut guide	531T	38.00
Adjustable guide for multiple panels	106AT	47.50
94 Series guide – stainless steel plate and precision bearing	106E/94	59.50
94 Series guide – large stainless steel mounting plate and precision bearing	106RB/94	78.00
94 Series guide – stainless steel angle plate with adjustable precision bearing	106A/94	61.50

## Guide channels

Description	Code	Price
2m 94 Series polypropylene channel – black	94P-20	22.00
2.5m 94 Series polypropylene channel – black	94P-25	26.50
3m 94 Series polypropylene channel – black	94P-30	34.50
4m 94 Series polypropylene channel – black	94P-40	41.50
5m 94 Series polypropylene channel – black	94P-50	49.00
6m 94 Series polypropylene channel – black	94P-60	62.00
2m 94 Series polypropylene channel with aluminium support – anodised finish	94PPA-A20	71.50
2.5m 94 Series polypropylene channel with aluminium support – anodised finish	94PPA-A25	91.50
3m 94 Series polypropylene channel with aluminium support – anodised finish	94PPA-A30	107.00
4m 94 Series polypropylene channel with aluminium support – anodised finish	94PPA-A40	131.00
5m 94 Series polypropylene channel with aluminium support – anodised finish	94PPA-A50	166.00
6m 94 Series polypropylene channel with aluminium support – anodised finish	94PPA-A60	195.00

# Brio Single Run 350

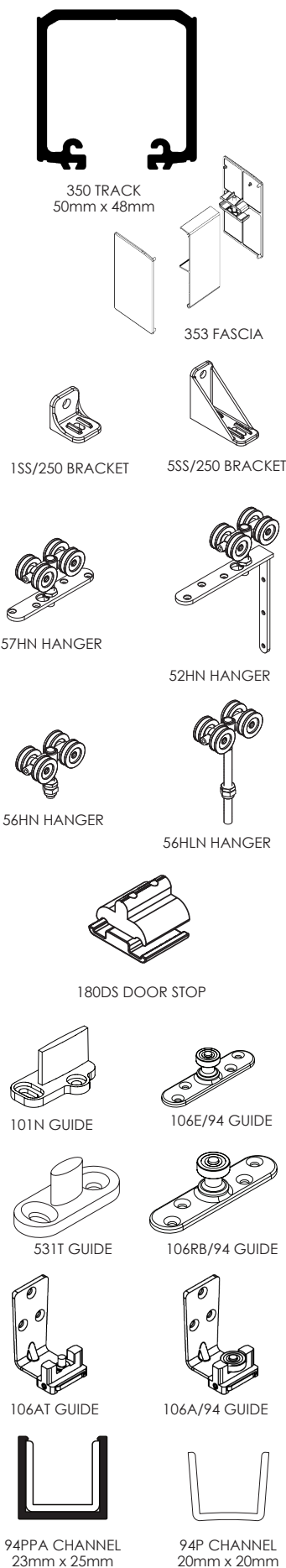

Maximum door weight	350kg
Minimum door thickness	35mm

## Tracks

Description	Code	Price
2m aluminium – anodised finish	350-A20	197.00
2.5m aluminium – anodised finish	350-A25	249.00
3m aluminium – anodised finish	350-A30	300.00
4m aluminium – anodised finish	350-A40	386.00
5m aluminium – anodised finish	350-A50	480.00
6m aluminium – anodised finish	350-A60	580.00

## Fascia

Description	Code	Price
2m Fascia and end cap set for 350 Track- anodised finish	353-20CA	169.00
3m Fascia and end cap set for 350 Track- anodised finish	353-30CA	231.00
4m Fascia and end cap set for 350 Track- anodised finish	353-40CA	285.00
6m Fascia and end cap set for 350 Track – anodised finish	353-60CA	396.00

## Track Brackets - for wall fixing track

Description	Code	Price
Heavy duty bracket – cast stainless steel	1SS/250	47.00
Heavy duty bracket for hanging two lines of track – cast stainless steel	5SS/250	146.00

## Door hangers - for timber doors (always use two per door)

Description	Code	Price
Type 52 – corner fixing plate with chrome steel bearings	52HN	260.00
Type 52 – corner fixing plate with stainless steel bearings	52SS/HN	387.00
Type 57 – top fixing plate with chrome steel bearings	57HN	234.00
Type 57 – top fixing plate with stainless steel bearings	57SS/HN	386.00

## Door hangers - for metal doors (always use two per door)

Description	Code	Price
Type 56 – short bolt fix	56HN	171.00
Type 56L – long bolt fix	56HLN	185.00

## Door stop

Description	Code	Price
Track mounted door stop	180DS	59.00

## Guides

Description	Code	Price
Stainless steel sawcut guide	531T	38.00
Adjustable guide for multiple panels	106AT	47.50
94 Series guide – stainless steel plate and precision bearing	106E/94	59.50
94 Series guide – large stainless steel mounting plate and precision bearing	106RB/94	78.00
94 Series guide – stainless steel angle plate with adjustable precision bearing	106A/94	61.50

## Guide channels

Description	Code	Price
2m 94 Series polypropylene channel – black	94P-20	22.00
2.5m 94 Series polypropylene channel – black	94P-25	26.50
3m 94 Series polypropylene channel – black	94P-30	34.50
4m 94 Series polypropylene channel – black	94P-40	41.50
5m 94 Series polypropylene channel – black	94P-50	49.00
6m 94 Series polypropylene channel – black	94P-60	62.00
2m 94 Series polypropylene channel with aluminium support – anodised finish	94PPA-A20	71.50
2.5m 94 Series polypropylene channel with aluminium support – anodised finish	94PPA-A25	91.50
3m 94 Series polypropylene channel with aluminium support – anodised finish	94PPA-A30	107.00
4m 94 Series polypropylene channel with aluminium support – anodised finish	94PPA-A40	131.00
5m 94 Series polypropylene channel with aluminium support – anodised finish	94PPA-A50	166.00
6m 94 Series polypropylene channel with aluminium support – anodised finish	94PPA-A60	195.00

# Brio Simultaneous

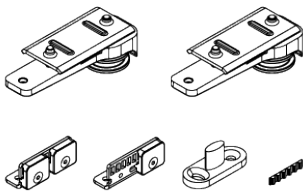

Simultaneous  
2 Panel Kit

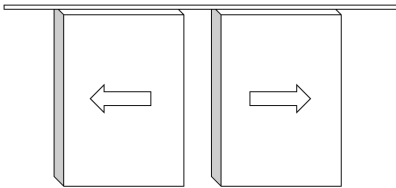

Compatible with the following systems:	Maximum door weight:
Single Run Exterior 120	100kg
Single Run 180	100kg
Single Run 350	100kg

## Fittings pack

Description	Code	Price
Simultaneous action kit for two panels	SIM/2	485.00

# Brio Telescopic

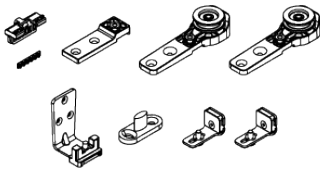

Telescopic  
2 Panel Kit

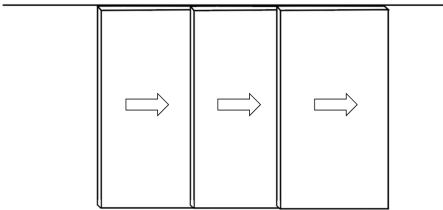

Compatible with the following systems:	Maximum door weight:
Quick Run 120	2 Door: 120kg, 3 Door:100kg
Single Run Exterior 120	2 Door: 120kg, 3 Door:100kg
Single Run 180	2 Door: 120kg, 3 Door:100kg
Single Run 350	2 Door: 120kg, 3 Door:100kg

## Fittings pack

Description	Code	Price
Telescopic kit for two panels	TEL/2	231.00
Telescopic kit for three panels	TEL/3	393.00

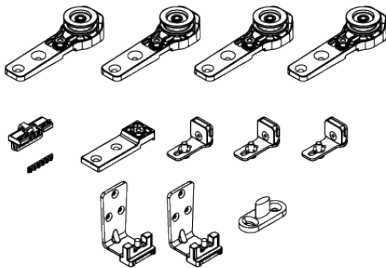

Telescopic  
3 Panel Kit



# Brio Zero Clearance 60

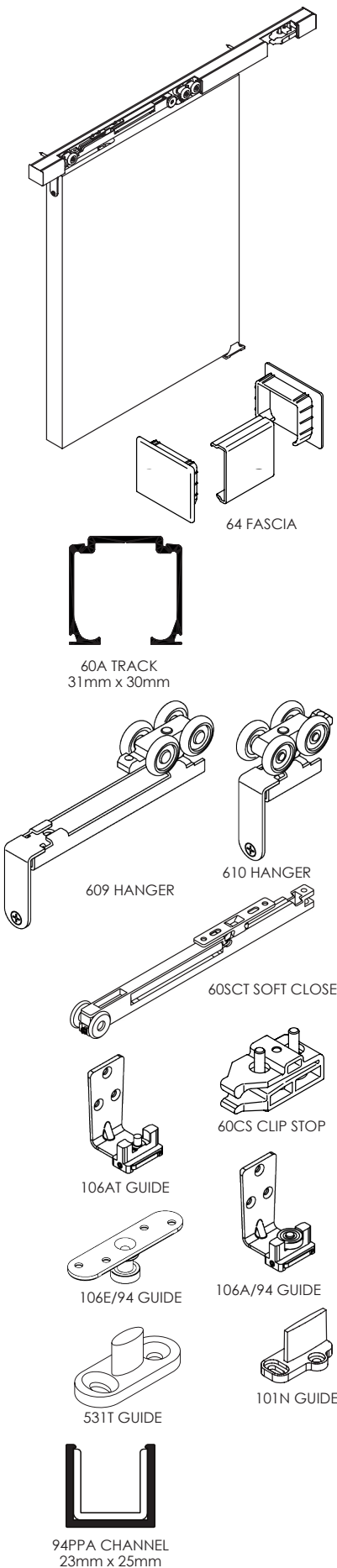

Maximum door weight	60kg
Minimum door thickness	28mm

Sets – include track and fittings for one door

Description	Code	Price
Kit suitable for one door, kit comprises: 2m length of aluminium track, two door hangers, two track mounted door stops, one sawcut guide and installation instructions.	ZC60-20/1	190.00
Kit suitable for one door, kit comprises: 3m length of aluminium track, two door hangers, two track mounted door stops, one sawcut guide and installation instructions.	ZC60-30/1	213.00

Fittings pack

Description	Code	Price
Fittings pack with all items needed to hang one door (excluding track), pack comprises of two door hangers, two door stops, one sawcut guide and installation instructions.	ZC60-1PK	143.00

Tracks

Description	Code	Price
2m aluminium – mill finish	60A-20	53.00
3m aluminium – mill finish	60A-30	78.50
4m aluminium – mill finish	60A-40	101.00
6m aluminium – mill finish	60A-60	131.00

Fascia

Description	Code	Price
2m Fascia and end cap set for Zero Clearance 60 – powder coated white	64-20PWT	116.00
3m Fascia and end cap set for Zero Clearance 60 – powder coated white	64-30PWT	174.00
2m Fascia and end cap set for Zero Clearance 60 – anodised	64-20CA	116.00
3m Fascia and end cap set for Zero Clearance 60 – anodised	64-30CA	174.00

Door hangers - for timber doors (always use two per door)

Description	Code	Price
Zero Clearance 60 hanger for use with 60CS clip stop	609	54.00
Zero Clearance 60 hanger for use with 60SCT soft close	610	54.00

Door stops and accessories

Description	Code	Price
Track mounted clip stop	60CS	16.50
Soft close unit	60SCT	71.50

Guides

Description	Code	Price
Sawcut guide – nylon – floor mounted	101N	5.30
Adjustable guide for multiple panels	106AT	47.50
94 Series guide – stainless steel plate and precision bearing	106E/94	59.50
94 Series guide – large stainless steel mounting plate and precision bearing	106RB/94	78.00
94 Series guide – stainless steel angle plate with adjustable precision bearing	106A/94	61.50

Guide channels

Description	Code	Price
2m 94 Series polypropylene channel with aluminium support – anodised finish	94PPA-A20	71.50
2.5m 94 Series polypropylene channel with aluminium support – anodised finish	94PPA-A25	91.50
3m 94 Series polypropylene channel with aluminium support – anodised finish	94PPA-A30	107.00
4m 94 Series polypropylene channel with aluminium support – anodised finish	94PPA-A40	131.00
5m 94 Series polypropylene channel with aluminium support – anodised finish	94PPA-A50	166.00
6m 94 Series polypropylene channel with aluminium support – anodised finish	94PPA-A60	195.00

# Brio Zero Clearance 180 and 350

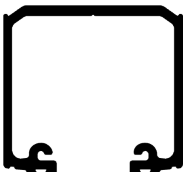

180A TRACK  
45mm x 47mm

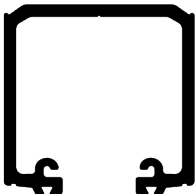

350 TRACK  
50mm x 48mm

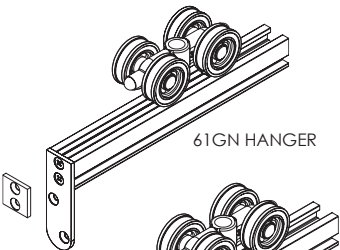

61GN HANGER

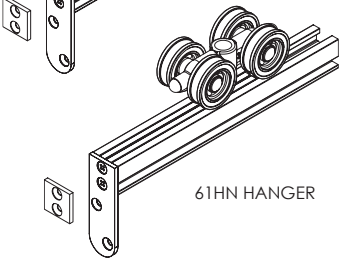

61HN HANGER

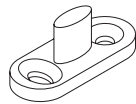

531T GUIDE

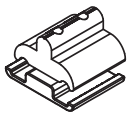

180DS DOOR STOP

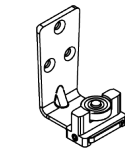

106A/94 GUIDE

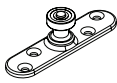

106E/94 GUIDE

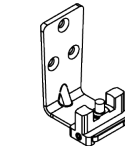

106AT GUIDE

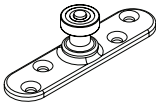

106RB/94 GUIDE

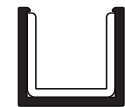

94PPA CHANNEL  
23mm x 25mm



94P CHANNEL  
20mm x 20mm

## 180

Maximum door weight	180kg
Minimum door thickness	40mm

## 350

350kg
40mm

### Tracks - aluminium anodised finish

Description	Code	Price
2m aluminium - anodised finish	180A-A20	149.00
2.5m aluminium - anodised finish	180A-A25	197.00
3m aluminium - anodised finish	180A-A30	227.00
4m aluminium - anodised finish	180A-A40	300.00
5m aluminium - anodised finish	180A-A50	370.00
6m aluminium - anodised finish	180A-A60	446.00

Code	Price
350-A20	197.00
350-A25	249.00
350-A30	300.00
350-A40	386.00
350-A50	480.00
350-A60	580.00

### Door hangers (always use two per door)

Description	Code	Price
Zero Clearance hanger	61GN	355.00

Code	Price
61HN	374.00

### Door stops

Description	Code	Price
Track mounted door stop	180DS	59.00

Code	Price
180DS	59.00

### Guides

Description	Code	Price
Stainless steel sawcut guide	531T	38.00
Adjustable guide for multiple panels	106AT	47.50
94 Series guide - stainless steel plate and precision bearing	106E/94	59.50
94 Series guide - large stainless steel mounting plate and precision bearing	106RB/94	78.00
94 Series guide - stainless steel angle plate with adjustable precision bearing	106A/94	61.50

### Guide channels

Description	Code	Price
2m 94 Series polypropylene channel - black	94P-20	22.00
2.5m 94 Series polypropylene channel - black	94P-25	26.50
3m 94 Series polypropylene channel - black	94P-30	34.50
4m 94 Series polypropylene channel - black	94P-40	41.50
5m 94 Series polypropylene channel - black	94P-50	49.00
6m 94 Series polypropylene channel - black	94P-60	62.00
2m 94 Series polypropylene channel with aluminium support - anodised finish	94PPA-A20	71.50
2.5m 94 Series polypropylene channel with aluminium support - anodised finish	94PPA-A25	91.50
3m 94 Series polypropylene channel with aluminium support - anodised finish	94PPA-A30	107.00
4m 94 Series polypropylene channel with aluminium support - anodised finish	94PPA-A40	131.00
5m 94 Series polypropylene channel with aluminium support - anodised finish	94PPA-A50	166.00
6m 94 Series polypropylene channel with aluminium support - anodised finish	94PPA-A60	195.00

# Brio Open Round Rail Glass 100

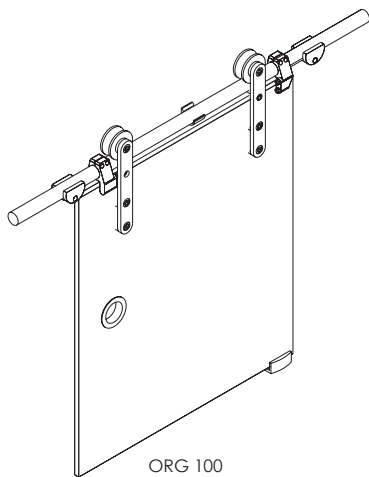

Maximum door weight	100kg
Maximum door height	3m
Glass thickness	8, 10 or 12mm

### Tracks

Description	Code	Price
2m Round rail with end caps – stainless steel	100OR-20	285.00
2.5m Round rail with end caps – stainless steel	100OR-25	356.00
3m Round rail with end caps – stainless steel	100OR-30	430.00
4m Round rail with end caps – stainless steel	100OR-40	570.00
2m Round rail with end caps – PVD black	100OR-20PR	386.00
2.5m Round rail with end caps – PVD black	100OR-25PR	481.00
3m Round rail with end caps – PVD black	100OR-30PR	580.00

### Additional wall mounting brackets

Description	Code	Price
None required for 2m track, one for 2.5m track, two for 3m track and four for 4m track		
Support bracket for Open Round Rail Glass 100 system – stainless steel	100-RB	37.00
Support bracket for Open Round Rail Glass 100 system – PVD black	100-RBPR	53.50

### Fittings packs

Description	Code	Price
Pack includes two door hangers, two doorstops, one guide, brackets and fixings		
Open Round Rail Glass 100 – fittings pack – stainless steel	ORG100	810.00
Open Round Rail Glass 100 – fittings pack – PVD black	ORG100PR	1,100.00

### Accessories for frameless glass doors

Description	Code	Price
Stainless steel adjustable guide 8mm – 13.5mm glass	531G	99.50

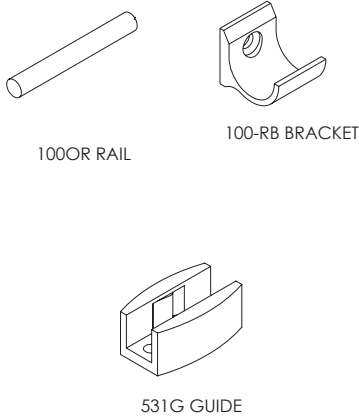

# Brio Open Bar Rail Timber 80

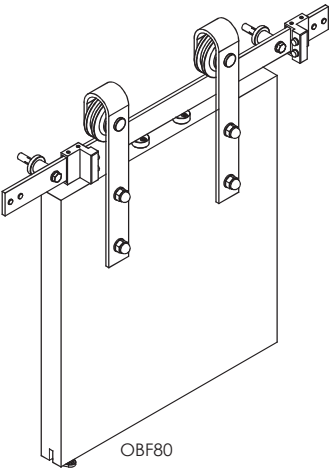

Maximum door weight	80kg
Maximum door width	1.1m
Door thickness	35-44mm

Sets - includes track and fittings for one door

Description	Code	Price
Open Bar Rail 80 kit - 2m powder coated black	OBF80-20PB	393.00
Open Bar Rail 80 kit - 2.5m powder coated black	OBF80-25PB	491.00
Open Bar Rail 80 kit - 2m stainless steel	OBF80-20	580.00
Open Bar Rail 80 kit - 2.5m stainless steel	OBF80-25	720.00
Open Bar Rail 80 - 2m antique bronze	OBF80-20ABZ	580.00
Open Bar Rail 80 - 2.5m antique bronze	OBF80-25ABZ	720.00

## Rail joiners

Description	Code	Price
Open Bar Rail 80 joining bracket - powder coated black	80B-JBPB	15.00
Open Bar Rail 80 joining bracket - stainless steel	80B-JB	22.00
Open Bar Rail 80 joining bracket - antique bronze	80B-JBABZ	22.00

Wall bracket spacer discs - use five for 2m rail, six for 2.5m rail

Description	Code	Price
Open Bar Rail 80 14mm spacer disc (use behind wall mounting brackets) - powder coated black	OBF80-PACKERPBK	5.80
Open Bar Rail 80 14mm spacer disc (use behind wall mounting brackets) - stainless steel	OBF80-PACKERSSS	9.20
Open Bar Rail 80 14mm spacer disc (use behind wall mounting brackets) - antique bronze	OBF80-PACKERABZ	9.20

## Guides

Description	Code	Price
Stainless steel sawcut guide - stainless steel	531T	38.00
Stainless steel sawcut guide - PVD black finish	531TPR	50.50
Adjustable guide for multiple panels	106AT	47.50
94 Series guide - stainless steel plate and precision bearing	106E/94	59.50
94 Series guide - large stainless steel mounting plate and precision bearing	106RB/94	78.00
94 Series guide - stainless steel angle plate with adjustable precision bearing	106A/94	61.50

## Guide channels

Description	Code	Price
2m 94 Series polypropylene channel - black	94P-20	20.00
2.5m 94 Series polypropylene channel - black	94P-25	24.00
3m 94 Series polypropylene channel - black	94P-30	31.50
4m 94 Series polypropylene channel - black	94P-40	37.50
5m 94 Series polypropylene channel - black	94P-50	44.50
6m 94 Series polypropylene channel - black	94P-60	56.50
2m 94 Series polypropylene channel with aluminium support - anodised finish	94PPA-A20	65.00
2.5m 94 Series polypropylene channel with aluminium support - anodised finish	94PPA-A25	83.00
3m 94 Series polypropylene channel with aluminium support - anodised finish	94PPA-A30	97.50
4m 94 Series polypropylene channel with aluminium support - anodised finish	94PPA-A40	119.00
5m 94 Series polypropylene channel with aluminium support - anodised finish	94PPA-A50	151.00
6m 94 Series polypropylene channel with aluminium support - anodised finish	94PPA-A60	177.00

## Accessories

Description	Code	Price
Soft Close Kit - includes two soft close units for soft-close in both opening and closing directions	OBF80-SCT	169.00

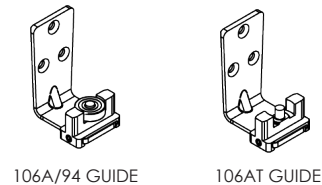

106A/94 GUIDE

106AT GUIDE

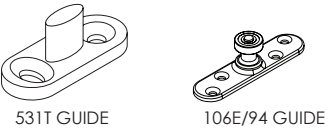

531T GUIDE

106E/94 GUIDE

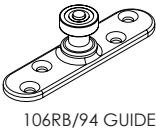

106RB/94 GUIDE

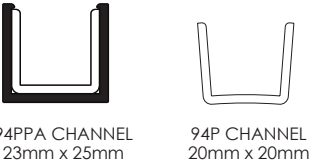

94PPA CHANNEL  
23mm x 25mm

94P CHANNEL  
20mm x 20mm

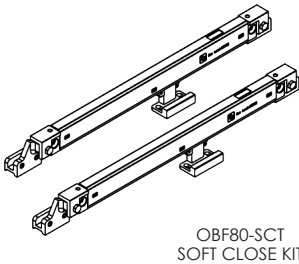

OBF80-SCT  
SOFT CLOSE KIT

# Brio Open Round Rail Timber 100

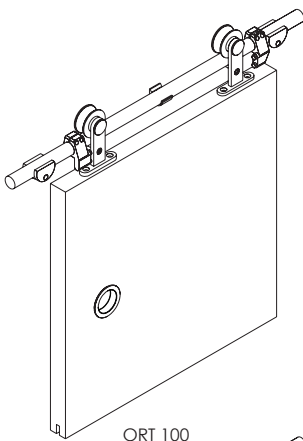

ORT 100

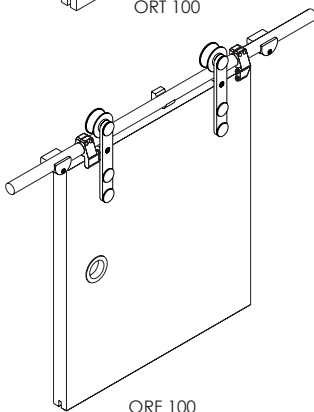

ORF 100

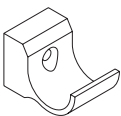

100F-RB BRACKET



100-RB BRACKET

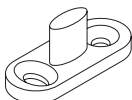

531T GUIDE

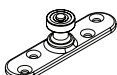

106E/94 GUIDE

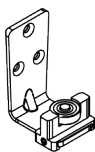

106A/94 GUIDE

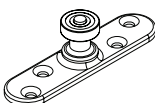

106RB/94 GUIDE



94PPA CHANNEL  
23mm x 25mm



94P CHANNEL  
20mm x 20mm



106AT GUIDE

Maximum door weight	100kg
Minimum door thickness	35-40mm

## Tracks

Description	Code	Price
2m Round rail with end caps - stainless steel	100OR-20	285.00
2.5m Round rail with end caps - stainless steel	100OR-25	356.00
3m Round rail with end caps - stainless steel	100OR-30	430.00
4m Round rail with end caps - stainless steel	100OR-40	570.00
2m Round rail with end caps - PVD black	100OR-20PR	386.00
2.5m Round rail with end caps - PVD black	100OR-25PR	481.00
3m Round rail with end caps - PVD black	100OR-30PR	580.00

## Fittings packs

Description	Code	Price
<b>Pack includes two door hangers, two doorstops, one guide, one flush pull, brackets and fixings</b>		
Open Round Rail Timber 100 - Top Fix - fittings pack - stainless steel	ORT100	660.00
Open Round Rail Timber 100 - Top Fix - fittings pack - PVD black	ORT100PR	885.00
Open Round Rail Timber 100 - Face Fix - fittings pack - stainless steel	ORF100	725.00
Open Round Rail Timber 100 - Face Fix - fittings pack - PVD black	ORF100PR	985.00

## Additional wall mounting brackets

Description	Code	Price
<b>None required for 2m track, one for 2.5m track, two for 3m track and four for 4m track</b>		
Support bracket for round rail (top fix system) - stainless steel	100-RB	37.00
Support bracket for round rail (top fix system) - PVD black	100-RBPR	53.50
Support bracket for round rail (face fix system) - stainless steel	100F-RB	48.50
Support bracket for round rail (face fix system) - PVD black	100F-RBPR	65.00

## Guides

Description	Code	Price
Stainless steel sawcut guide	531T	38.00
Stainless steel sawcut guide - PVD black finish	531TPR	50.50
Adjustable guide for multiple panels	106AT	47.50
94 Series guide - stainless steel plate and precision bearing	106E/94	59.50
94 Series guide - large stainless steel mounting plate and precision bearing	106RB/94	78.00
94 Series guide - stainless steel angle plate with adjustable precision bearing	106A/94	61.50

## Guide channels

Description	Code	Price
2m 94 Series polypropylene channel - black	94P-20	22.00
2.5m 94 Series polypropylene channel - black	94P-25	26.50
3m 94 Series polypropylene channel - black	94P-30	34.50
4m 94 Series polypropylene channel - black	94P-40	41.50
5m 94 Series polypropylene channel - black	94P-50	49.00
6m 94 Series polypropylene channel - black	94P-60	62.00
2m 94 Series polypropylene channel with aluminium support - anodised finish	94PPA-A20	71.50
2.5m 94 Series polypropylene channel with aluminium support - anodised finish	94PPA-A25	91.50
3m 94 Series polypropylene channel with aluminium support - anodised finish	94PPA-A30	107.00
4m 94 Series polypropylene channel with aluminium support - anodised finish	94PPA-A40	131.00
5m 94 Series polypropylene channel with aluminium support - anodised finish	94PPA-A50	166.00
6m 94 Series polypropylene channel with aluminium support - anodised finish	94PPA-A60	195.00

# Brio Open Square Rail Timber 150

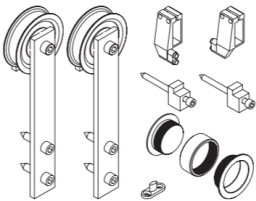
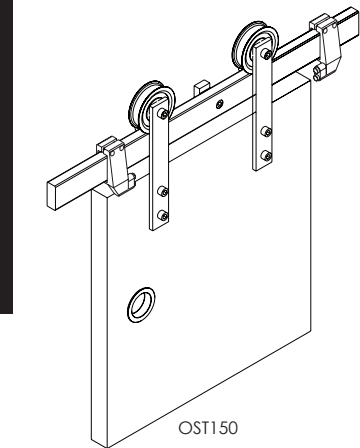

OST150 FITTINGS PACK

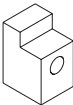

150-SB BRACKET

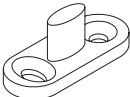

531T GUIDE

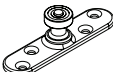

106E/94 GUIDE

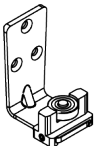

106A/94 GUIDE



106RB/94 GUIDE



94PPA CHANNEL  
23mm x 25mm



94P CHANNEL  
20mm x 20mm

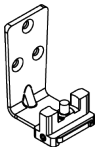

106AT GUIDE

Maximum door weight	150kg
Minimum door thickness	35-44mm

## Tracks

Description	Code	Price
2m Square rail with end caps - stainless steel	150SR-20	855.00
2.5m Square rail with end caps - stainless steel	150SR-25	950.00
3m Square rail with end caps - stainless steel	150SR-30	1,190.00
4m Square rail with end caps - stainless steel	150SR-40	1,520.00
2m Square rail with end caps - PVD black	150SR-20PR	1,210.00
2.5m Square rail with end caps - PVD black	150SR-25PR	1,530.00
3m Square rail with end caps - PVD black	150SR-30PR	1,610.00

## Fittings packs

Description	Code	Price
Pack includes two door hangers, two doorstops, one guide, one flush pull, brackets and fixings		
Open Square Rail 150 fittings pack - stainless steel	OST150	1,130.00
Open Square Rail 150 fittings pack - PVD black	OST150PR	1,540.00

## Additional wall mounting brackets

Description	Code	Price
None required for 2m track, one for 2.5m track, two for 3m track and four for 4m track		
Wall fixing bracket for square rail - stainless steel	150-SB	106.00
Wall fixing bracket for square rail - PVD black	150-SBPR	142.00

## Guides

Description	Code	Price
Stainless steel sawcut guide - stainless steel	531T	38.00
Stainless steel sawcut guide - PVD black	531TPR	50.50
Adjustable guide for multiple panels	106AT	47.50
94 Series guide - stainless steel plate and precision bearing	106E/94	59.50
94 Series guide - large stainless steel mounting plate and precision bearing	106RB/94	78.00
94 Series guide - stainless steel angle plate with adjustable precision bearing	106A/94	61.50

## Guide channels

Description	Code	Price
2m 94 Series polypropylene channel - black	94P-20	22.00
2.5m 94 Series polypropylene channel - black	94P-25	26.50
3m 94 Series polypropylene channel - black	94P-30	34.50
4m 94 Series polypropylene channel - black	94P-40	41.50
5m 94 Series polypropylene channel - black	94P-50	49.00
6m 94 Series polypropylene channel - black	94P-60	62.00
2m 94 Series polypropylene channel with aluminium support - anodised finish	94PPA-A20	71.50
2.5m 94 Series polypropylene channel with aluminium support - anodised finish	94PPA-A25	91.50
3m 94 Series polypropylene channel with aluminium support - anodised finish	94PPA-A30	107.00
4m 94 Series polypropylene channel with aluminium support - anodised finish	94PPA-A40	131.00
5m 94 Series polypropylene channel with aluminium support - anodised finish	94PPA-A50	166.00
6m 94 Series polypropylene channel with aluminium support - anodised finish	94PPA-A60	195.00

# Brio Wardrobe Roll 50

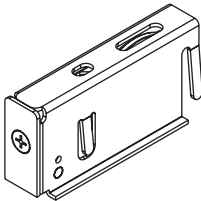
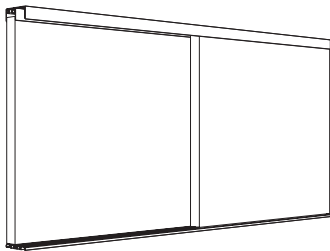

50WR ROLLER

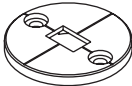

50G GUIDE DISC



53C SILL COVER CLIP

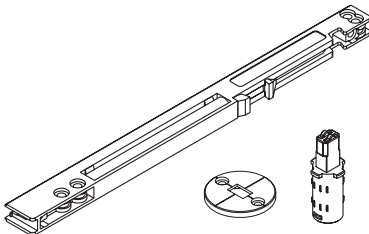

50SCL SOFT CLOSE KIT



55 HEAD EXTRUSION



53 SILL EXTRUSION



56 SILL COVER

Maximum door weight	50kg
Door thickness	30-40mm

## Sets - white

Description	Code	Price
Kit suitable for two doors, comprising: 1.2m sill extrusion, 1.2m head extrusion, 1.2m sill cover extrusion, sill cover clips, four door rollers, four guides, all screws and installation instructions.	WR50-12/2PWT	157.00
Kit suitable for two doors, comprising: 1.5m sill extrusion, 1.5m head extrusion, 1.5m sill cover extrusion, sill cover clips, four door rollers, four guides, all screws and installation instructions.	WR50-15/2PWT	168.00
Kit suitable for two doors, comprising: 1.8m sill extrusion, 1.8m head extrusion, 1.8m sill cover extrusion, sill cover clips, four door rollers, four guides, all screws and installation instructions.	WR50-18/2PWT	186.00
Kit suitable for three doors, comprising: 2.4m sill extrusion, 2.4m head extrusion, 2.4m sill cover extrusion, sill cover clips, six door rollers, six guides, all screws and installation instructions.	WR50-24/3PWT	220.00
Kit with softclose, suitable for two doors, comprising: 1.2m sill extrusion, 1.2m head extrusion, 1.2m sill cover extrusion, sill cover clips, four door rollers, four guides, two lightweight softclose units, all screws and installation instructions.	WR50L-12/2PWT	248.00
Kit with softclose, suitable for two doors, comprising: 1.5m sill extrusion, 1.5m head extrusion, 1.5m sill cover extrusion, sill cover clips, four door rollers, four guides, two lightweight softclose units, all screws and installation instructions.	WR50L-15/2PWT	260.00
Kit with softclose, suitable for two doors, comprising: 1.8m sill extrusion, 1.8m head extrusion, 1.8m sill cover extrusion, sill cover clips, four door rollers, four guides, all screws and installation instructions.	WR50L-18/2PWT	275.00
Kit with softclose, suitable for three doors, comprising: 2.4m sill extrusion, 2.4m head extrusion, 2.4m sill cover extrusion, sill cover clips, six door rollers, six guides, three lightweight softclose units, all screws and installation instructions.	WR50L-24/3PWT	355.00

## Sets - clear anodised

Description	Code	Price
Kit suitable for two doors, comprising: 1.2m sill extrusion, 1.2m head extrusion, 1.2m sill cover extrusion, sill cover clips, four door rollers, four guides, all screws and installation instructions.	WR50-12/2CA	157.00
Kit suitable for two doors, comprising: 1.5m sill extrusion, 1.5m head extrusion, 1.5m sill cover extrusion, sill cover clips, four door rollers, four guides, all screws and installation instructions.	WR50-15/2CA	168.00
Kit suitable for two doors, comprising: 1.8m sill extrusion, 1.8m head extrusion, 1.8m sill cover extrusion, sill cover clips, four door rollers, four guides, all screws and installation instructions.	WR50-18/2CA	186.00
Kit suitable for three doors, comprising: 2.4m sill extrusion, 2.4m head extrusion, 2.4m sill cover extrusion, sill cover clips, six door rollers, six guides, all screws and installation instructions.	WR50-24/3CA	220.00
Kit with softclose, suitable for two doors, comprising: 1.2m sill extrusion, 1.2m head extrusion, 1.2m sill cover extrusion, sill cover clips, four door rollers, four guides, two lightweight softclose units, all screws and installation instructions.	WR50L-12/2CA	248.00
Kit with softclose, suitable for two doors, comprising: 1.5m sill extrusion, 1.5m head extrusion, 1.5m sill cover extrusion, sill cover clips, four door rollers, four guides, two lightweight softclose units, all screws and installation instructions.	WR50L-15/2CA	260.00
Kit with softclose, suitable for two doors, comprising: 1.8m sill extrusion, 1.8m head extrusion, 1.8m sill cover extrusion, sill cover clips, four door rollers, four guides, two lightweight softclose units, all screws and installation instructions.	WR50L-18/2CA	275.00
Kit with softclose, suitable for three doors, comprising: 2.4m sill extrusion, 2.4m head extrusion, 2.4m sill cover extrusion, sill cover clips, six door rollers, six guides, three lightweight softclose units, all screws and installation instructions.	WR50L-24/3CA	355.00

## Fittings pack

Description	Code	Price
Fittings pack containing two adjustable rollers, two guides to hang one door and eight sill cover clips	WR50-1PK	36.00

## Components and accessories

Description	Code	Price
Guide Disc	50G	2.10
Wardrobe Roll 50 Bottom Roller	50WR	14.50
Sill Cover Clip - 8 pack	53C/8	23.50
Soft close kit (for one door, soft closing in one direction) up to 20kg door	50SCL	47.50

## Extrusions

Description	Code	Price
3.8m Double sill extrusion - white	53-38PWT	89.50
3.8m Double head extrusion - white	55-38PWT	131.00
3.8m Sill cover extrusion - white	56-38PWT	18.50
3.8m Double sill extrusion - clear anodised	53-A38	89.50
3.8m Double head extrusion - clear anodised	55-A38	131.00
3.8m Sill cover extrusion - clear anodised	56-A38	18.50
5m Double sill extrusion - white	53-50PWT	118.00
5m Double head extrusion - white	55-50PWT	173.00
5m Sill cover extrusion - white	56-50PWT	25.00
5m Double sill extrusion - clear anodised	53-A50	118.00
5m Double head extrusion - clear anodised	55-A50	173.00
5m Sill cover extrusion - clear anodised	56-A50	25.00

# Brio Wardrobe Roll Trio 50

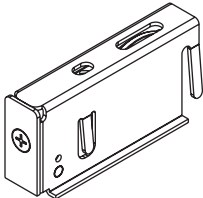
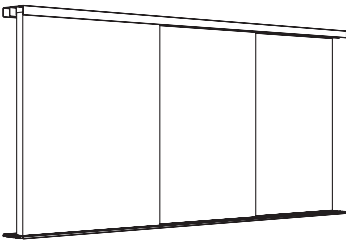

50WR ROLLER



50G GUIDE



53C SILL COVER CLIP

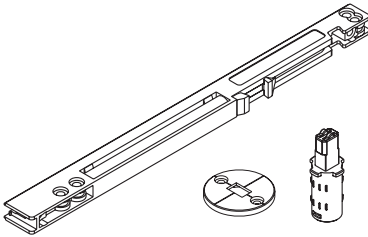

50SCL SOFT CLOSE KIT

Maximum door weight	50kg
Door thickness	30–40mm

## Sets - white

Description	Code	Price
Kit suitable for three doors, comprising: 1.8m sill extrusion, 1.8m head extrusion, 1.8m sill cover extrusions, sill cover clips, six door rollers, six guides, all screws and installation instructions.	WT50-18/3PWT	341.00
Kit suitable for three doors, comprising: 2.1m sill extrusion, 2.1m head extrusion, 2.1m sill cover extrusions, sill cover clips, six door rollers, six guides, all screws and installation instructions.	WT50-21/3PWT	364.00
Kit suitable for three doors, comprising: 2.4m sill extrusion, 2.4m head extrusion, 2.4m sill cover extrusions, sill cover clips, six door rollers, six guides, all screws and installation instructions.	WT50-24/3PWT	388.00
Kit suitable for three doors, comprising: 2.7m sill extrusion, 2.7m head extrusion, 2.7m sill cover extrusions, sill cover clips, six door rollers, six guides, all screws and installation instructions.	WT50-27/3PWT	414.00
Kit with softclose, suitable for three doors, comprising: 1.8m sill extrusion, 1.8m head extrusion, 1.8m sill cover extrusions, sill cover clips, six door rollers, six guides, three lightweight softclose units, all screws and installation instructions.	WT50L-18/3PWT	483.00
Kit with softclose, suitable for three doors, comprising: 2.1m sill extrusion, 2.1m head extrusion, 2.1m sill cover extrusions, sill cover clips, six door rollers, six guides, three lightweight softclose units, all screws and installation instructions.	WT50L-21/3PWT	505.00
Kit with softclose, suitable for three doors, comprising: 2.4m sill extrusion, 2.4m head extrusion, 2.4m sill cover extrusions, sill cover clips, six door rollers, six guides, three lightweight softclose units, all screws and installation instructions.	WT50L-24/3PWT	530.00
Kit with softclose, suitable for three doors, comprising: 2.7m sill extrusion, 2.7m head extrusion, 2.7m sill cover extrusions, sill cover clips, six door rollers, six guides, three lightweight softclose units, all screws and installation instructions.	WT50L-27/3PWT	555.00

## Sets - clear anodised

Description	Code	Price
Kit suitable for three doors, comprising: 1.8m sill extrusion, 1.8m head extrusion, 1.8m sill cover extrusions, sill cover clips, six door rollers, six guides, all screws and installation instructions.	WT50-18/3CA	341.00
Kit suitable for three doors, comprising: 2.1m sill extrusion, 2.1m head extrusion, 2.1m sill cover extrusions, sill cover clips, six door rollers, six guides, all screws and installation instructions.	WT50-21/3CA	364.00
Kit suitable for three doors, comprising: 2.4m sill extrusion, 2.4m head extrusion, 2.4m sill cover extrusions, sill cover clips, six door rollers, six guides, all screws and installation instructions.	WT50-24/3CA	388.00
Kit suitable for three doors, comprising: 2.7m sill extrusion, 2.7m head extrusion, 2.7m sill cover extrusions, sill cover clips, six door rollers, six guides, all screws and installation instructions.	WT50-27/3CA	414.00
Kit with softclose, suitable for three doors, comprising: 1.8m sill extrusion, 1.8m head extrusion, 1.8m sill cover extrusions, sill cover clips, six door rollers, six guides, three lightweight softclose units, all screws and installation instructions.	WT50L-18/3CA	483.00
Kit with softclose, suitable for three doors, comprising: 2.1m sill extrusion, 2.1m head extrusion, 2.1m sill cover extrusions, sill cover clips, six door rollers, six guides, three lightweight softclose units, all screws and installation instructions.	WT50L-21/3CA	505.00
Kit with softclose, suitable for three doors, comprising: 2.4m sill extrusion, 2.4m head extrusion, 2.4m sill cover extrusions, sill cover clips, six door rollers, six guides, three lightweight softclose units, all screws and installation instructions.	WT50L-24/3CA	530.00
Kit with softclose, suitable for three doors, comprising: 2.7m sill extrusion, 2.7m head extrusion, 2.7m sill cover extrusions, sill cover clips, six door rollers, six guides, three lightweight softclose units, all screws and installation instructions.	WT50L-27/3CA	555.00

## Fittings pack

Description	Code	Price
Fittings pack containing two adjustable rollers, two guides to hang one door and eight sill cover clips	WR50-1PK	36.00

## Components and accessories

Description	Code	Price
Guide Disc	50G	2.10
Wardrobe Roll 50 Trio roller	50WR	14.50
Sill cover clip - 8 pack	53C/8	23.50
Soft close kit (for one door, soft closing in one direction) up to 20kg door	50SCL	47.50

## Extrusions

Description	Code	Price
5m Triple sill extrusion - white	57-50PWT	250.00
5m Triple head extrusion - white	58-50PWT	261.00
5m Sill cover extrusion - white	56-50PWT	25.00
5m Triple sill extrusion - clear anodised	57-A50	250.00
5m Triple head extrusion - clear anodised	58-A50	261.00
5m Sill cover extrusion - clear anodised	56-A50	25.00



58 HEAD EXTRUSION



57 SILL EXTRUSION



56 SILL COVER



# Brio Timberoll

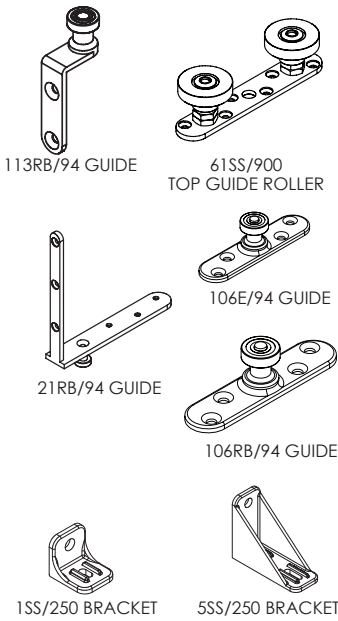
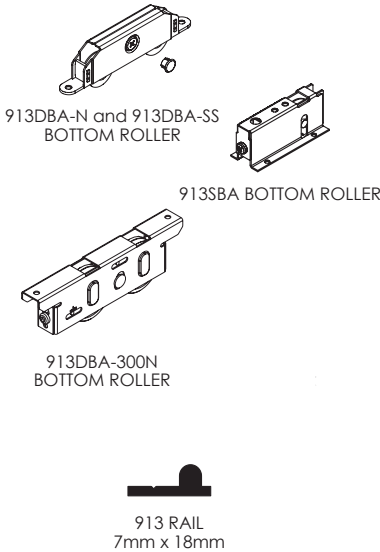

Maximum door weight	100kg / 170kg / 200kg / 300kg
Minimum door thickness	40mm

## Rollers

Description	Code	Price
Timberoll 100 double wheel – nylon self levelling roller with vertical adjustment	913DBA-N	68.00
Timberoll 170 single wheel – stainless steel roller with vertical adjustment	913SBA	72.50
Timberoll 200 double wheel – stainless steel self levelling double roller with vertical adjustment	913DBA-SS	120.00
Timberoll 300N double wheel – nylon self levelling double roller with vertical adjustment	913DBA-300N	187.00

## Surface mounted rails – suitable for Timberoll 100, 170, 200 and 300N rollers

Description	Code	Price
2m 913 Series rail – aluminium – anodised – drilled and countersunk	913A-A20	53.50
3m 913 Series rail – aluminium – anodised – drilled and countersunk	913A-A30	80.50
4m 913 Series rail – aluminium – anodised – drilled and countersunk	913A-A40	102.00
6m 913 Series rail – aluminium – anodised – drilled and countersunk	913A-A60	153.00
2m 913 Series rail – brass – drilled and countersunk	913B-20	168.00
3m 913 Series rail – brass – drilled and countersunk	913B-30	222.00
4m 913 Series rail – brass – drilled and countersunk	913B-40	328.00
6m 913 Series rail – brass – drilled and countersunk	913B-60	431.00

## Guides

Description	Code	Price
900 Series anti-rattle adjustable nylon roller with stainless steel top plate	61SS/900	212.00
94 Series guide – stainless steel plate and precision bearing – small plate	106E/94	59.50
94 Series guide – stainless steel plate and precision bearing – large plate	106RB/94	78.00
Corner plate fixing – stainless steel bearing – small cast stainless steel plate	113RB/94	58.00
Corner plate fixing – stainless steel bearing – large cast stainless steel plate	21RB/94	112.00

## Wall mounting brackets for 900 Series channel

Description	Code	Price
Wall fixed – single line – cast stainless steel	1SS/250	47.00
Wall fixed – double line – cast stainless steel	5SS/250	146.00

# Brio Guide channels

For straight sliding doors



92 CHANNEL  
9mm x 26mm



94 CHANNEL  
20mm x 21mm

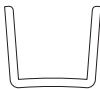

94P CHANNEL  
20mm x 20mm



94PPA CHANNEL  
23mm x 25mm



96W CHANNEL  
15mm x 24mm



900 CHANNEL  
30mm x 46mm

## Guide channels

Description	Code	Price
92 Series 4m threshold guide channel - aluminium - anodised finish	92-A40	156.00
92 Series 6m threshold guide channel - aluminium - anodised finish	92-A60	210.00
94 Series 2m aluminium channel - anodised finish	94A-A20	45.00
94 Series 3m aluminium channel - anodised finish	94A-A30	57.00
94 Series 4m aluminium channel - anodised finish	94A-A40	92.00
94 Series 6m aluminium channel - anodised finish	94A-A60	113.00
94 Series 2m polypropylene channel - black	94P-20	22.00
94 Series 2.5m polypropylene channel - black	94P-25	26.50
94 Series 3m polypropylene channel - black	94P-30	34.50
94 Series 4m polypropylene channel - black	94P-40	41.50
94 Series 5m polypropylene channel - black	94P-50	49.00
94 Series 6m polypropylene channel - black	94P-60	62.00
94 Series 2m polypropylene channel with aluminium support - anodised finish	94PPA-A20	71.50
94 Series 2.5m polypropylene channel with aluminium support - anodised finish	94PPA-A25	91.50
94 Series 3m polypropylene channel with aluminium support - anodised finish	94PPA-A30	107.00
94 Series 4m polypropylene channel with aluminium support - anodised finish	94PPA-A40	131.00
94 Series 5m polypropylene channel with aluminium support - anodised finish	94PPA-A50	166.00
94 Series 6m polypropylene channel with aluminium support - anodised finish	94PPA-A60	195.00
96 Series 2m aluminium channel - anodised finish	96W-A20	54.00
96 Series 3m aluminium channel - anodised finish	96W-A30	81.00
96 Series 4m aluminium channel - anodised finish	96W-A40	107.00
96 Series 6m aluminium channel - anodised finish	96W-A60	162.00
900 Series 4m anodised aluminium guide channel	900A-A40	289.00
900 Series 6m anodised aluminium guide channel	900A-A60	432.00

# Brio Guides and accessories

For straight sliding doors

## Guides

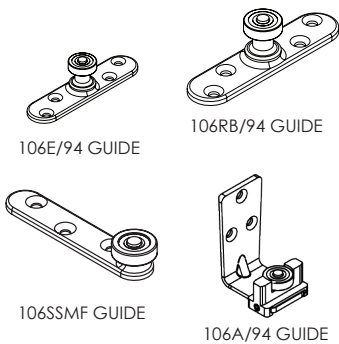

Description	Code	Price
Sawcut guide – nylon – floor mounted	101N	5.30
Stainless steel sawcut guide – stainless steel	531T	38.00
Stainless steel sawcut guide – PVD Black	531TPR	50.50
92 Series spring loaded guide – stainless steel	801S	14.50
Adjustable guide for multiple panels	106AT	47.50
94 Series guide – stainless steel plate and precision bearing – small mounting plate	106E/94	59.50
94 Series guide – stainless steel plate and precision bearing – large mounting plate	106RB/94	78.00
94 Series guide – stainless steel angle plate with adjustable precision bearing	106A/94	61.50
96 Series guide – stainless steel plate and nylon tyred precision bearing	106SSMF	56.00

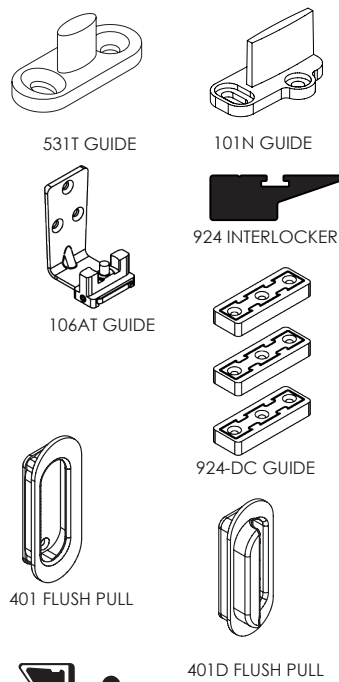

## Interlockers

Description	Code	Price
924 interlocker – clear anodised 2.4m (pack of two)	924-CA24	233.00
924 interlocker – clear anodised 4.8m	924-CA48	246.00
924 interlocker – black anodised 2.4m (pack of two)	924-BK24	285.00
924 interlocker – black anodised 4.8m	924-BK48	297.00
Door collector kit	924-DC	21.50

## Flush pulls

Description	Code	Price
Flush pull – satin nickel (H105mm x W41mm x D11mm)	401SN	50.50
Flush pull with raised finger grip – satin nickel (H105mm x W41mm x D11mm)	401DSN	99.50
58mm Ø stainless steel pull – adjustable for 35-44mm thick doors	535T	112.00

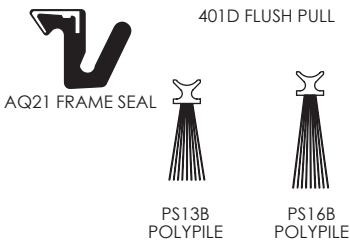

## Track and perimeter seals

Description	Code	Price
AQ21 frame seal – black – 1m unit	AQ21BL/1	7.80
AQ21 frame seal – white – 1m unit	AQ21W/1	7.80
13mm Track seal – 1m unit	PS13B/1	2.90
16mm Track seal – 1m unit	PS16B/1	3.90

## Floor / wall mounted door stop

Description	Code	Price
Door stop – satin chrome	110SC	20.50



# Brio Multifold 30

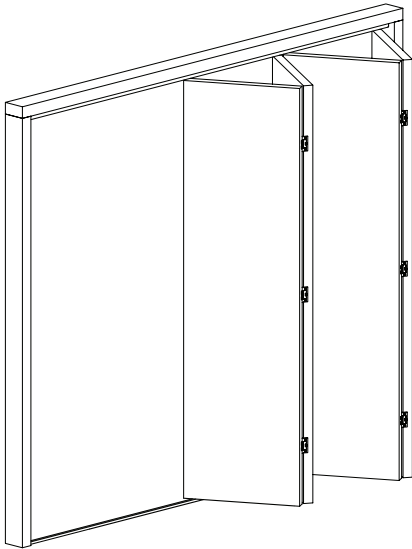

Maximum door leaf weight	30kg
Maximum door leaf height	2.4m
Maximum door leaf width	650mm
Minimum door leaf thickness	19mm

Sets - include track and fittings

Description	Code	Price
Kit suitable for two door leaves, pack comprises: 1.3m length of track, one pivot set, one door hanger, one door stop, three flush hinges, one spanner, all screws and installation instructions.	MF30-13/2	122.00

## Fittings packs

Description	Code	Price
Fittings pack with all items needed to hang two doors. Pack comprises: one pivot set, one door hanger, one door stop, three flush hinges, one spanner, all screws and installation instructions.	MF30-2PACK	110.00
Fittings pack with all items needed to hang four doors (moving in one direction). Pack comprises: one pivot set, two door hangers, one door stop, nine flush hinges, one spanner, all screws and installation instructions.	MF30-4PACK	194.00

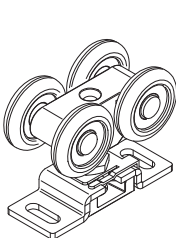

607 HANGER

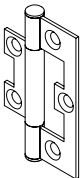

282 HINGE

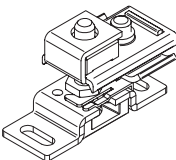

818 TOP PIVOT

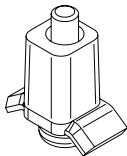

60DS DOOR STOP



802 BOTTOM PIVOT

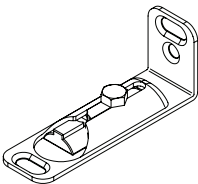

806 WALL BRACKET

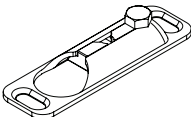

805 FLOOR BRACKET



801S GUIDE



92 CHANNEL  
9mm x 26mm

## Components

Description	Code	Price
1.3m aluminium track - mill finish	60A-13	39.00
2m aluminium track - mill finish	60A-20	53.00
3m aluminium track - mill finish	60A-30	78.50
4m aluminium track - mill finish	60A-40	101.00
6m aluminium track - mill finish	60A-60	131.00
Door Hanger - nylon body with top fixing plate	607	34.50
Track mounted door stop	60DS	8.30
Top pivot assembly	818	23.50
Bottom pivot	802	26.50
Wall bracket	806	23.00
Floor bracket	805	19.50
Non mortice hinge 65 x 38 x 1.5mm - zinc plated steel with screws	282Z	7.60
Non mortice hinge 65 x 38 x 1.5mm - stainless steel with screws	282SS	13.00
Guide - spring loaded - for use with 92 threshold channel	801S	14.50
Spanner for 606 hanger	805-SPN	6.10
4m 92 Series threshold guide channel - aluminium - anodised finish	92-A40	156.00
6m 92 Series threshold guide channel - aluminium - anodised finish	92-A60	210.00
2m 96 Series aluminium channel - anodised finish	96W-A20	54.00
3m 96 Series aluminium channel - anodised finish	96W-A30	81.00
4m 96 Series aluminium channel - anodised finish	96W-A40	107.00
6m 96 Series aluminium channel - anodised finish	96W-A60	162.00
96 Series guide - stainless steel plate and nylon tyred precision bearing	106SSMF	56.00

# Brio Pivotfold, Centrefold and Endfold

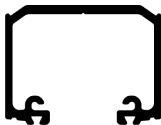

120A TRACK  
30mm x 41mm

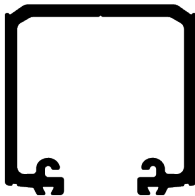

350 TRACK  
50mm x 48mm

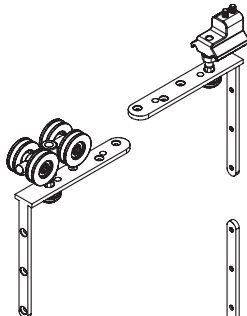

21/4 HANGER

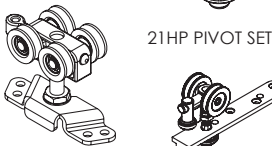

21HP PIVOT SET

35ENP HANGER



21HN HANGER

61/4 HANGER



106SSMF GUIDE

106RB/94 GUIDE

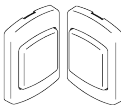

828

Maximum door leaf weight	35kg
Maximum door leaf height	2.4m
Maximum door leaf width	900mm
Maximum door leaf width (Centrefold)	920mm
Door leaf thickness	35-50mm

75kg
3.3m
900mm
1000mm
44-50mm

## Tracks

Description	Code	Price
2m aluminium - anodised finish	120A-A20	69.00
3m aluminium - anodised finish	120A-A30	105.00
4m aluminium - anodised finish	120A-A40	124.00
6m aluminium - anodised finish	120A-A60	189.00

Code	Price
350-A20	197.00
350-A30	300.00
350-A40	386.00
350-A60	580.00

## Pivot sets - Pivotfold only

Description	Code	Price
Top and bottom pivot set - for use with bottom channel		
Top and bottom pivot set - no bottom channel required	35EP	122.00

Code	Price
21HP-C	352.00
21HP	352.00

## Door hangers - Pivotfold and Endfold

Description	Code	Price
Two wheel end hanger		
Four wheel end or intermediate hanger	35ENP	69.00

Code	Price
21HN	240.00
21/4HN	274.00

## Door hangers - Centrefold

Description	Code	Price
Four wheel end or intermediate hanger	35ENP	69.00

Code	Price
61/4HN	305.00

## Guides - Pivotfold and Endfold

Description	Code	Price
94 Series guide - stainless steel plate and precision bearing	106E/94	59.50
94 Series guide - stainless steel angle plate and precision bearing	113RB/94	58.00
96 Series guide - stainless steel plate and nylon tyred precision bearing	106SSMF	56.00

Code	Price
106RB/94	78.00
21RB/94	112.00

## Guides - Centrefold

Description	Code	Price
94 Series guide - stainless steel plate and precision bearing	106E/94	59.50
96 Series guide - stainless steel plate and nylon tyred precision bearing	106SSMF	56.00

Code	Price
106RB/94	78.00

## Accessories

Description	Code	Price
Spanner for 57ENP and 35EP	M78-SPN	6.50
Surface mounted magnetic catch (two piece) - satin nickel	828SN	59.50
Surface mounted magnetic catch (two piece) - black	828PBK	59.50

# Brio Interfold 35F and 50F

No bottom guide required - two or four panel units only

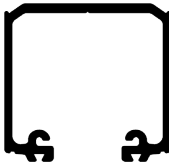

180A TRACK  
45mm x 47mm

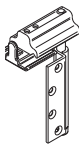

BWS1F-35H

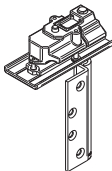

BWS1F-75H

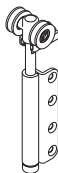

BWS2F-35CM

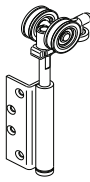

BWS2F-50CH

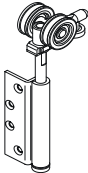

BWS2F-50CM

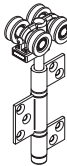

BWS4F-35CH

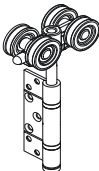

BWS4F-50CH

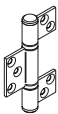

BW3

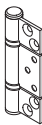

BW5



BW6

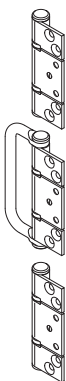

BW7

## 35F

Maximum door leaf weight	35kg
Maximum door leaf height	2.6m
Maximum door leaf width	820mm
Minimum door leaf thickness	35mm

## 50F

50kg
2.6m
820mm
35mm

## Tracks

Description	Code	Price
2m aluminium - anodised finish	120A-A20	69.00
3m aluminium - anodised finish	120A-A30	105.00
4m aluminium - anodised finish	120A-A40	124.00
6m aluminium - anodised finish	120A-A60	189.00

Code	Price
180A-A20	149.00
180A-A30	227.00
180A-A40	300.00
180A-A60	446.00

## Pivot sets - non-mortice

Description	Code	Price
Sets consists of top pivot and jamb pivot		
Pivot set - satin stainless steel	BWS1F-35HSS	252.00

Code	Price
BWS1F-75HSS	378.00

## Jamb pivots - non-mortice (for use with tall doors)

Description	Code	Price
Jamb pivot - satin stainless steel		

Code	Price
BW189HSS	143.00

## End door hangers - non-mortice

Description	Code	Price
End hanger only		
End hanger - satin stainless steel	BWS2F-35CHSS	152.00

Code	Price
BWS2F-50CHSS	284.00

## End door hangers - morticed

Description	Code	Price
End hanger only		
End hanger - satin stainless steel	BWS2F-35CMSS	165.00

Code	Price
BWS2F-50CMSS	309.00

## Intermediate door hanger sets - non-mortice

Description	Code	Price
Sets consist of one hanger and two hinges		
Intermediate hanger set - satin stainless steel	BWS4F-35CHSS	321.00

Code	Price
BWS4F-50CHSS	389.00

## Hinge sets - non-mortice

Description	Code	Price
Stainless steel fixed pin ball bearing hinges		
Intermediate hinge handle set - two hinges and one hinge handle - SSS	BW3-35HSS	147.00
Intermediate hinge set - three hinges - satin stainless steel	BW5-35HSS	141.00
Offset hinge set - three offset hinges - satin stainless steel	BW6-35HSS	141.00
Offset hinge set - two hinges and one hinge handle - satin stainless steel	BW7-35HSS	147.00

Code	Price
BW3-100HSS	161.00
BW5-100HSS	157.00
BW6-100HSS	157.00
BW7-100HSS	163.00

## Single hinges - non-mortice

Description	Code	Price
Stainless steel fixed pin ball bearing hinges		
Intermediate hinge - satin stainless steel	125HS	49.00
Intermediate hinge handle - satin stainless steel	126HS	52.50
Offset hinge - satin stainless steel	129HS	49.00
Offset hinge handle - satin stainless steel	129GHS	52.50

Code	Price
BW215HSS	53.50
BW216HSS	70.00
BW219HSS	53.50
BW220HSS	70.00

# Brio Interfold 35 and 50

Bottom guide required

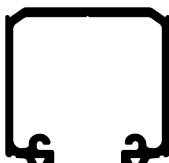

180A TRACK  
45mm x 47mm



96W CHANNEL  
15mm x 24mm



94PPA CHANNEL  
23mm x 25mm

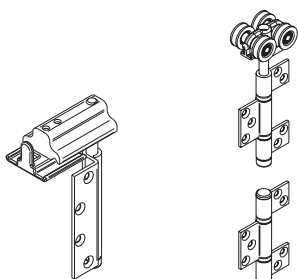

BWS1F-35H

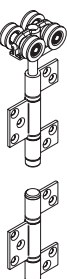

BWS4-35CH

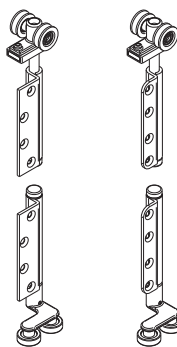

BW2R-35CH BWSR-35CM

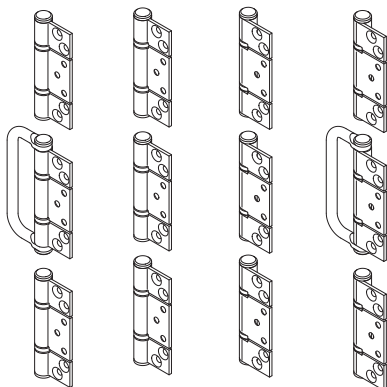

BW3

BW5

BW6

BW7

## 35

Maximum door leaf weight	35kg
Maximum door leaf height	2.6m
Maximum door leaf width	1m
Minimum door leaf thickness	35mm

## 50

50kg
3m
1m
35mm

## Tracks

Description	Code	Price
2m aluminium - anodised finish	120A-A20	69.00
3m aluminium - anodised finish	120A-A30	105.00
4m aluminium - anodised finish	120A-A40	124.00
6m aluminium - anodised finish	120A-A60	189.00

Code	Price
180A-A20	149.00
180A-A30	227.00
180A-A40	300.00
180A-A60	446.00

## Guide channels

Description	Code	Price
2m aluminium channel - anodised finish (50kg inc polypropylene insert)	96W-A20	54.00
3m aluminium channel - anodised finish (50kg inc polypropylene insert)	96W-A30	81.00
4m aluminium channel - anodised finish (50kg inc polypropylene insert)	96W-A40	107.00
6m aluminium channel - anodised finish (50kg inc polypropylene insert)	96W-A60	162.00

Code	Price
94PPA-A20	71.50
94PPA-A30	107.00
94PPA-A40	131.00
94PPA-A60	195.00

## Pivot sets - non-mortice

Description	Code	Price
Sets consist of top pivot and jamb pivot		
Pivot set - satin stainless steel	BWS1F-35HSS	252.00

Code	Price
BWS1F-75HSS	378.00

## Jamb pivots - non-mortice (for use with tall doors)

Description	Code	Price
Jamb pivot - satin stainless steel		

Code	Price
BW189HSS	143.00

## Intermediate door hanger sets - non-mortice

Description	Code	Price
Sets consists of hanger, guide and one hinge		
Intermediate hanger set - satin stainless steel	BWS4-35CHSS	375.00

Code	Price
BWS4-50CHSS	520.00

## End door hanger sets - non-mortice

Description	Code	Price
Sets consist of end hanger and guide		
End hanger set - right - satin stainless steel	BWS2R-35CHSS	266.00
End hanger set - left - satin stainless steel	BWS2L-35CHSS	266.00
End hanger set - non handed - satin stainless steel		

Code	Price
BWS2-50CHSS	419.00

## End door hanger sets - morticed

Description	Code	Price
Sets consist of end hanger and guide		
End hanger set - right - satin stainless steel	BWS2R-35CMSS	283.00
End hanger set - left - satin stainless steel	BWS2L-35CMSS	283.00
End hanger set - non handed - satin stainless steel		

Code	Price
BWS2-50CMSS	472.00
BWS2-50CMSS	472.00
BWS2-50CMSS	472.00

## Hinge sets - non-mortice

Description	Code	Price
Stainless steel fixed pin ball bearing hinges		
Intermediate hinge handle set - two hinges and one hinge handle - satin stainless steel	BW3-35HSS	147.00
Intermediate hinge set - three hinges - satin stainless steel	BW5-35HSS	141.00
Offset hinge set - three offset hinges - satin stainless steel	BW6-35HSS	141.00
Offset hinge set - two hinges and one hinge handle - satin stainless steel	BW7-35HSS	147.00

Code	Price
BW3-100HSS	161.00
BW5-100HSS	157.00
BW6-100HSS	157.00
BW7-100HSS	163.00

# Brio

Guide channels, hinges and accessories

For folding doors



94 CHANNEL  
20mm x 21mm



94P CHANNEL  
20mm x 20mm



94PPA CHANNEL  
23mm x 25mm



96W CHANNEL  
15mm x 24mm

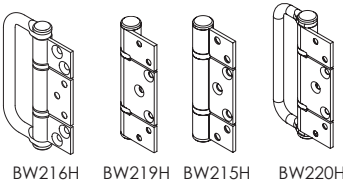

BW216H

BW219H

BW215H

BW220H

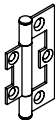

282 HINGE



129HS



125HS

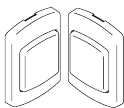

828

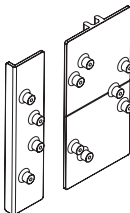

BW-DJH1

## Guide channels

Description	Code	Price
2m 94 Series aluminium channel – anodised finish	94A-A20	45.00
3m 94 Series aluminium channel – anodised finish	94A-A30	57.00
4m 94 Series aluminium channel – anodised finish	94A-A40	92.00
6m 94 Series aluminium channel – anodised finish	94A-A60	113.00
2m 94 Series polypropylene channel – black	94P-20	22.00
2.5m 94 Series polypropylene channel – black	94P-25	26.50
3m 94 Series polypropylene channel – black	94P-30	34.50
4m 94 Series polypropylene channel – black	94P-40	41.50
5m 94 Series polypropylene channel – black	94P-50	49.00
6m 94 Series polypropylene channel – black	94P-60	62.00
2m 94 Series polypropylene channel with aluminium support – anodised finish	94PPA-A20	71.50
2.5m 94 Series polypropylene channel with aluminium support – anodised finish	94PPA-A25	91.50
3m 94 Series polypropylene channel with aluminium support – anodised finish	94PPA-A30	107.00
4m 94 Series polypropylene channel with aluminium support – anodised finish	94PPA-A40	131.00
5m 94 Series polypropylene channel with aluminium support – anodised finish	94PPA-A50	166.00
6m 94 Series polypropylene channel with aluminium support – anodised finish	94PPA-A60	195.00
2m 96 Series aluminium channel – anodised finish	96W-A20	54.00
3m 96 Series aluminium channel – anodised finish	96W-A30	81.00
4m 96 Series aluminium channel – anodised finish	96W-A40	107.00
6m 96 Series aluminium channel – anodised finish	96W-A60	162.00

## Hinges - non-mortice

Description	Code	Price
Non mortice hinge 65 x 38 x 1.5mm – zinc plated steel with screws	282Z	7.60
Non mortice hinge 65 x 38 x 1.5mm – stainless steel with screws	282SS	13.00
Non mortice ball bearing hinge 85 x 57 x 2.5mm – satin stainless steel	125HS	49.00
Non mortice ball bearing hinge handle 85 x 57 x 2.5mm – satin stainless steel	126HS	52.50
Non mortice ball bearing offset hinge 85 x 57 x 2.5mm – satin stainless steel	129HS	49.00
Non mortice ball bearing offset hinge handle 85 x 57 x 2.5mm – satin stainless steel	1296HS	52.50
Non mortice ball bearing hinge 100 x 65 x 3mm – satin stainless steel	BW215HSS	53.50
Non mortice ball bearing hinge handle 100 x 65 x 3mm – satin stainless steel	BW216HSS	70.00
Non mortice ball bearing offset hinge 100 x 65 x 3mm – satin stainless steel	BW219HSS	53.50
Non mortice ball bearing offset hinge handle 100 x 65 x 3mm – satin stainless steel	BW220HSS	70.00

## Magnetic catches

Description	Code	Price
Surface mounted magnetic catch (two piece) – satin nickel	828SN	59.50
Surface mounted magnetic catch (two piece) – black	828PBK	59.50

## Accessories

Description	Code	Price
Drilling jig for non-mortice hinges (Interfold 50 / 50F)	BW-DJH1	11.50



# Brio Weatherfold 4s Servery 35

No bottom guide required - two panel or two + two panel layouts only

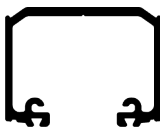

120A TRACK  
30mm x 41mm

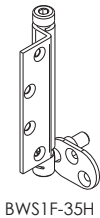
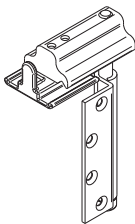

BWS1F-35H

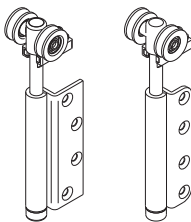

BWS2F-35SH

BWS2F-35SM



BW3-35H

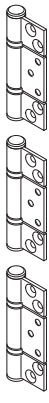

BW5-35H



BW6-35H



BW7-35H



129HS



125HS

Maximum door leaf weight	35kg
Maximum door leaf height	1.8m
Maximum door leaf width	650mm
Minimum door leaf thickness	35mm

## Tracks

Description	Code	Price
2m aluminium - anodised finish	120A-A20	69.00
3m aluminium - anodised finish	120A-A30	105.00
4m aluminium - anodised finish	120A-A40	124.00
6m aluminium - anodised finish	120A-A60	189.00

## Pivot set - non-mortice

Description	Code	Price
<b>Sets consist of top pivot and jamb pivot</b>		
Pivot set - satin stainless steel	BWS1F-35HSS	252.00

## End door hanger - non-morticed

Description	Code	Price
<b>End hanger only</b>		
End hanger - satin stainless steel	BWS2F-35SHSS	160.00

## End door hanger - morticed (also suitable for rebated doors)

Description	Code	Price
<b>End hanger only</b>		
End hanger - satin stainless steel	BWS2F-35SMSS	167.00

## Hinge sets - non-mortice

Description	Code	Price
<b>Consists of three 85 x 57 x 2.5mm stainless steel fixed pin ball bearing hinges per set</b>		
Intermediate hinge set - two hinges and one hinge handle - satin stainless steel	BW3-35HSS	147.00
Intermediate hinge set - three hinges - satin stainless steel	BW5-35HSS	141.00
Offset hinge set - three hinges - satin stainless steel	BW6-35HSS	141.00
Offset hinge set - two hinges and one hinge handle - satin stainless steel	BW7-35HSS	147.00

## Single hinges - non-mortice

Description	Code	Price
<b>85 x 57 x 2.5mm stainless steel fixed pin ball bearing hinges</b>		
Intermediate hinge - satin stainless steel	125HS	49.00
Intermediate hinge handle - satin stainless steel	126HS	52.50
Offset hinge - satin stainless steel	129HS	49.00
Offset hinge handle - satin stainless steel	1296HS	52.50

# Brio Weatherfold 4s Window 35

Bottom guide required



120A TRACK  
30mm x 41mm



96W CHANNEL  
15mm x 24mm

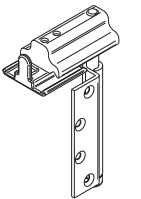

BWS1F-35H

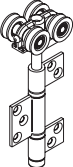

BWS4-35SH

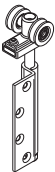

BW2R-35SH

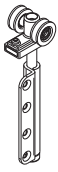

BWSR-35SM

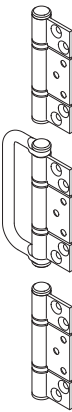

BW3-35H



BW5-35H

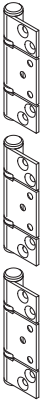

BW6-35H

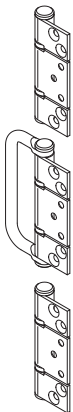

BW7-35H

Maximum door leaf weight	35kg
Maximum door leaf height	1.8m
Maximum door leaf width	1m
Minimum door leaf thickness	35mm

## Tracks

Description	Code	Price
2m aluminium – anodised finish	120A-A20	69.00
3m aluminium – anodised finish	120A-A30	105.00
4m aluminium – anodised finish	120A-A40	124.00
6m aluminium – anodised finish	120A-A60	189.00

## Guide channels

Description	Code	Price
2m 96 Series aluminium channel – anodised finish	96W-A20	54.00
3m 96 Series aluminium channel – anodised finish	96W-A30	81.00
4m 96 Series aluminium channel – anodised finish	96W-A40	107.00
6m 96 Series aluminium channel – anodised finish	96W-A60	162.00

## Pivot set - non-mortice

Description	Code	Price
<b>Sets consist of top pivot and jamb pivot</b>		
Pivot set – satin stainless steel	BWS1F-35HSS	252.00

## Intermediate door hanger set - non-mortice

Description	Code	Price
<b>Sets consist of hanger, guide and one hinge</b>		
Intermediate hanger set – satin stainless steel	BWS4-35SHSS	384.00

## End door hanger sets - non-mortice

Description	Code	Price
<b>Sets consist of end hanger and guide</b>		
End hanger set – right – satin stainless steel	BWS2R-35SHSS	271.00
End hanger set – left – satin stainless steel	BWS2L-35SHSS	271.00

## End door hanger sets - morticed (also suitable for rebated doors)

Description	Code	Price
<b>Sets consist of hanger and guide</b>		
End hanger set – right – satin stainless steel	BWS2R-35SMSS	295.00
End hanger set – left – satin stainless steel	BWS2L-35SMSS	295.00

## Hinge sets - non-mortice

Description	Code	Price
<b>Sets consist of three 85 x 57 x 2.5mm stainless steel fixed pin ball bearing hinges per set</b>		
Intermediate hinge set – two hinges and one hinge handle – satin stainless steel	BW3-35HSS	147.00
Intermediate hinge set – inward opening – three hinges – satin stainless steel	BW5-35HSS	141.00
Offset hinge set – three hinges – satin stainless steel	BW6-35HSS	141.00
Offset hinge set – two hinges and one hinge handle – satin stainless steel	BW7-35HSS	147.00

## Single hinges - non-mortice

Description	Code	Price
<b>85 x 57 x 2.5mm stainless steel fixed pin ball bearing hinges</b>		
Intermediate hinge – satin stainless steel	125HS	49.00
Intermediate hinge handle – satin stainless steel	126HS	52.50
Offset hinge – satin stainless steel	129HS	49.00
Offset hinge handle – satin stainless steel	1296HS	52.50

# Brio Weatherfold 4s 50 and 100

For timber and aluminium doors - non-mortice

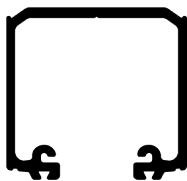

180A TRACK  
45mm x 47mm

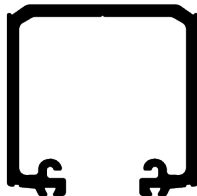

350 TRACK  
50mm x 48mm

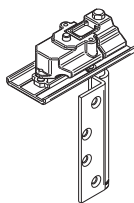

BWS1-100H

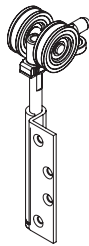

BWS2-100SH

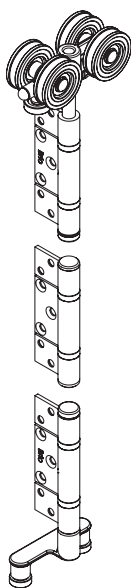

BWS4-100SH

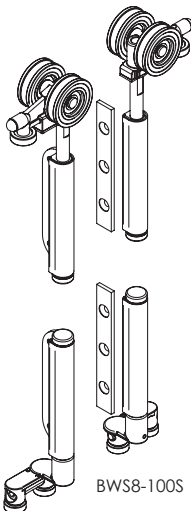

BWS8-100S

Maximum leaf weight	50kg
Maximum leaf height	3m
Maximum leaf width	1m
Leaf thickness	35-68mm

100kg
3.3m
1m
35-68mm

## Tracks

Description	Code	Price
2m aluminium - anodised finish	180A-A20	149.00
2.5m aluminium - anodised finish	180A-A25	197.00
3m aluminium - anodised finish	180A-A30	227.00
4m aluminium - anodised finish	180A-A40	300.00
5m aluminium - anodised finish	180A-A50	370.00
6m aluminium - anodised finish	180A-A60	446.00

Code	Price
350-A20	197.00
350-A25	249.00
350-A30	300.00
350-A40	386.00
350-A50	480.00
350-A60	580.00

## Pivot sets - non-mortice

Description	Code	Price
Sets consist of top and bottom pivots		
Pivot set - satin stainless steel	BWS1-100HSS	378.00
Pivot set - PVD Black	BWS1-100HPR	416.00

Code	Price
BWS1-100HSS	378.00
BWS1-100HPR	416.00

## Jamb pivots - non-mortice

Description	Code	Price
Jamb pivot - satin stainless steel	BW189HSS	143.00
Jamb pivot - PVD Black	BW189HPR	157.00

Code	Price
BW189HSS	143.00
BW189HPR	157.00

## Intermediate door hanger sets - non-mortice

Description	Code	Price
Sets consist of hanger, guide and one hinge		
Intermediate hanger set - satin stainless steel	BWS4-50SHSS	565.00
Intermediate hanger set - PVD Black	BWS4-50SHPR	620.00

Code	Price
BWS4-100SHSS	645.00
BWS4-100SHPR	705.00

## End door hanger sets - for rebated doors

Description	Code	Price
Sets consist of top hanger and bottom guide		
End hanger set - satin stainless steel	BWS2-50SHSS	505.00
End hanger set - PVD Black	BWS2-50SHPR	555.00

Code	Price
BWS2-100SHSS	580.00
BWS2-100SHPR	640.00

## End door hanger sets - for rebated doors

Description	Code	Price
Sets consist of top hanger and bottom guide		
End hanger set for rebated doors - satin stainless steel	BWS2-50SRSS	505.00
End hanger set for rebated doors - PVD Black	BWS2-50SRPR	555.00

Code	Price
BWS2-100SRSS	580.00
BWS2-100SRPR	640.00

## End door hanger sets - face mounted

Description	Code	Price
Sets consist of top hanger and bottom guide		
End hanger set - satin stainless steel	BWS2-50SFSS	491.00

Code	Price
BWS2-100SFSS	565.00

## Meeting door hanger sets - for rebated doors

Description	Code	Price
Sets consists of two hangers and two guides - one set for the rebated door and one set for surface mounting		
Meeting rebated door set - satin stainless steel	BWS8-50SSS	985.00

Code	Price
BWS8-100SSS	1,130.00

# Brio Weatherfold 4s 50 and 100

For timber and aluminium doors - non-mortice

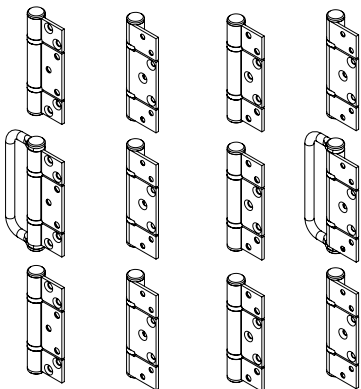

BW3-100H    BW6-100H    BW5-100H    BW7-100H

## Hinge sets - 50 / 100kg non-mortice

Description	Code	Price
100 x 65 x 3mm stainless steel fixed pin ball bearing hinges		
Hinge set - two hinges and one hinge handle - satin stainless steel	BW3-100HSS	161.00
Hinge set - three hinges no hinge handle - satin stainless steel	BW5-100HSS	157.00
Offset hinge set - three hinges no hinge handle - satin stainless steel	BW6-100HSS	157.00
Offset hinge set - two hinges and one hinge handle - satin stainless steel	BW7-100HSS	163.00
Hinge set - two hinges and one hinge handle - PVD Black	BW3-100HPR	179.00
Hinge set - three hinges no hinge handle - PVD Black	BW5-100HPR	174.00
Offset hinge set - three hinges no hinge handle - PVD Black	BW6-100HPR	174.00
Offset hinge set - two hinges and one hinge handle - PVD Black	BW7-100HPR	179.00

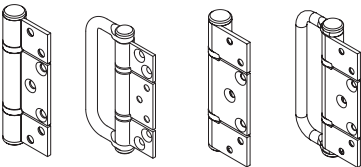

BW215H    BW216H    BW219H    BW220H

## Single hinges - 50 / 100kg non-mortice

Description	Code	Price
100 x 65 x 3mm stainless steel fixed pin ball bearing hinges		
Intermediate hinge - satin stainless steel	BW215HSS	53.50
Intermediate hinge handle - satin stainless steel	BW216HSS	70.00
Offset hinge - satin stainless steel	BW219HSS	53.50
Offset hinge handle - satin stainless steel	BW220HSS	70.00
Intermediate hinge - PVD Black	BW215HPR	58.00
Intermediate hinge handle - PVD Black	BW216HPR	76.50
Offset hinge - PVD Black	BW219HPR	58.00
Offset hinge handle - PVD Black	BW220HPR	76.50

## Guide channels



94 CHANNEL  
20mm x 21mm

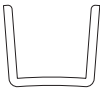

94P CHANNEL  
20mm x 20mm



94PPA CHANNEL  
23mm x 25mm

Description	Code	Price
2m 94 series aluminium channel - anodised finish	94A-A20	45.00
3m 94 series aluminium channel - anodised finish	94A-A30	57.00
4m 94 series aluminium channel - anodised finish	94A-A40	92.00
6m 94 series aluminium channel - anodised finish	94A-A60	113.00
2m 94 series polypropylene channel - black	94P-20	22.00
2.5m 94 series polypropylene channel - black	94P-25	26.50
3m 94 series polypropylene channel - black	94P-30	34.50
4m 94 series polypropylene channel - black	94P-40	41.50
5m 94 series polypropylene channel - black	94P-50	49.00
6m 94 series polypropylene channel - black	94P-60	62.00
2m 94 series polypropylene channel with aluminium support - anodised finish	94PPA-A20	71.50
2.5m 94 series polypropylene channel with aluminium support - anodised finish	94PPA-A25	91.50
3m 94 series polypropylene channel with aluminium support - anodised finish	94PPA-A30	107.00
4m 94 series polypropylene channel with aluminium support - anodised finish	94PPA-A40	131.00
5m 94 series polypropylene channel with aluminium support - anodised finish	94PPA-A50	166.00
6m 94 series polypropylene channel with aluminium support - anodised finish	94PPA-A60	195.00

# Brio Weatherfold 4s 50 and 100

For timber doors – square mortice

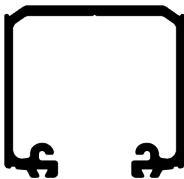

180A TRACK  
45mm x 47mm

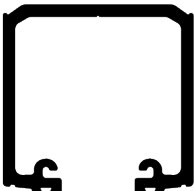

350 TRACK  
50mm x 48mm

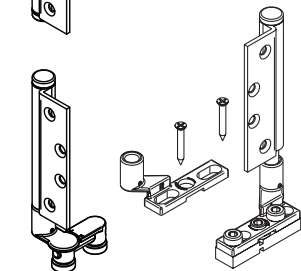
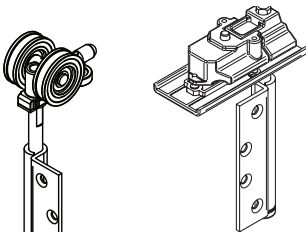

BWS2-100SM

BWS1-100M

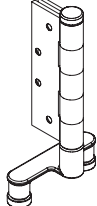
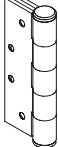
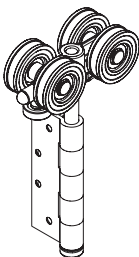

BWS4-100SM

Maximum door leaf weight	50kg
Maximum door leaf height	3m
Maximum door leaf width	1m
Door leaf thickness	35-68mm

100kg
3.3m
1m
35-68mm

## Tracks

Description	Code	Price
2m aluminium – anodised finish	180A-A20	149.00
2.5m aluminium – anodised finish	180A-A25	197.00
3m aluminium – anodised finish	180A-A30	227.00
4m aluminium – anodised finish	180A-A40	300.00
5m aluminium – anodised finish	180A-A50	370.00
6m aluminium – anodised finish	180A-A60	446.00

Code	Price
350-A20	197.00
350-A25	249.00
350-A30	300.00
350-A40	386.00
350-A50	480.00
350-A60	580.00

## Pivot sets - square mortice

Description	Code	Price
Sets consist of top and bottom pivots		
Pivot set – satin stainless steel	BWS1-100MSS	398.00
Pivot set – polished brass	BWS1-100MPB	465.00

Code	Price
BWS1-100MSS	398.00
BWS1-100MPB	465.00

## Jamb pivots - square mortice

Description	Code	Price
Jamb pivot – satin stainless steel	BW189MSS	151.00
Jamb pivot – polished brass	BW189MPB	165.00

Code	Price
BW189MSS	151.00
BW189MPB	165.00

## Intermediate door hanger sets - square mortice

Description	Code	Price
Sets consist of hanger, guide and one hinge		
Intermediate hanger set – satin stainless steel	BWS4-50SMSS	625.00
Intermediate hanger set – polished brass	BWS4-50SMPB	775.00

Code	Price
BWS4-100SMSS	675.00
BWS4-100SMPB	810.00

## End door hanger sets - square mortice

Description	Code	Price
Sets consist of top hanger and bottom guide		
End hanger set – stainless steel	BWS2-50SMSS	525.00
End hanger set – polished brass	BWS2-50SMPB	625.00

Code	Price
BWS2-100SMSS	645.00
BWS2-100SMPB	760.00

## End door hanger sets – for rebated doors

Description	Code	Price
Sets consist of top hanger and bottom guide		
End hanger set for rebated doors – satin stainless steel	BWS2-50SRSS	505.00
End hanger set for rebated doors – polished brass	BWS2-50SRPB	570.00

Code	Price
BWS2-100SRSS	580.00
BWS2-100SRPB	675.00

## End door hanger sets - face mounted

Description	Code	Price
Sets consist of top hanger and bottom guide		
End hanger set – satin stainless steel	BWS2-50SFSS	491.00
End hanger set – polished brass	BWS2-50SF PB	565.00

Code	Price
BWS2-100SFSS	565.00
BWS2-100SF PB	680.00

## Meeting door hanger sets – for rebated doors

Description	Code	Price
Sets consists of two hangers and two guides - one set for the rebated door and one set for surface mounting		
Meeting rebated door set – satin stainless steel	BWS8-50SSS	985.00
Meeting rebated door set – polished brass	BWS8-50SPB	1,030.00

Code	Price
BWS8-100SSS	1,130.00
BWS8-100SPB	1,290.00

# Brio Weatherfold 4s 50 and 100

For timber doors - square mortice

## Hinge sets - 50 / 100kg - square mortice

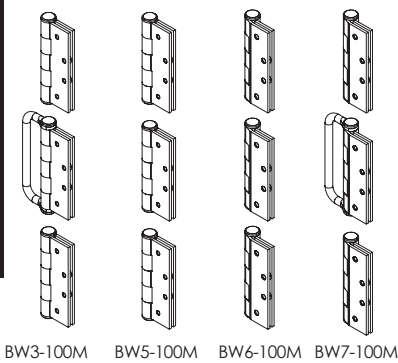

Description	Code	Price
<b>100 x 65 x 3mm stainless steel fixed pin hinges</b>		
Intermediate hinge handle set - two hinges and one hinge handle - satin stainless steel	BW3-100MSS	183.00
Intermediate hinge set - three hinges - satin stainless steel	BW5-100MSS	168.00
Offset hinge set - three offset hinges - satin stainless steel	BW6-100MSS	165.00
Offset hinge set - two hinges and one hinge handle - satin stainless steel	BW7-100MSS	183.00
Intermediate hinge set - two hinges and one hinge handle - polished brass	BW3-100MPB	211.00
Intermediate hinge set - three hinges - polished brass	BW5-100MPB	211.00
Offset hinge set - three hinges - polished brass	BW6-100MPB	200.00
Offset hinge handle set - two hinges and one hinge handle - polished brass	BW7-100MPB	211.00

## Single hinges - 50 / 100kg - square mortice

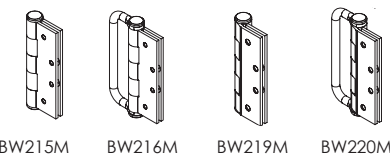

Description	Code	Price
<b>100 x 65 x 3mm stainless steel fixed pin hinges</b>		
Intermediate hinge - satin stainless steel	BW215MSS	62.50
Hinge handle - satin stainless steel	BW216MSS	69.00
Offset hinge - satin stainless steel	BW219MSS	66.00
Offset hinge handle - satin stainless steel	BW220MSS	82.50
Intermediate hinge only - polished brass	BW215MPB	72.50
Hinge handle - polished brass	BW216MPB	86.00
Offset hinge - polished brass	BW219MPB	72.50
Offset hinge handle - polished brass	BW220MPB	97.50

## Guide channels



Description	Code	Price
2m 94 Series aluminium channel - anodised finish	94A-A20	45.00
3m 94 Series aluminium channel - anodised finish	94A-A30	57.00
4m 94 Series aluminium channel - anodised finish	94A-A40	92.00
6m 94 Series aluminium channel - anodised finish	94A-A60	113.00
2m 94 Series polypropylene channel - black	94P-20	22.00
2.5m 94 Series polypropylene channel - black	94P-25	26.50
3m 94 Series polypropylene channel - black	94P-30	34.50
4m 94 Series polypropylene channel - black	94P-40	41.50
5m 94 Series polypropylene channel - black	94P-50	49.00
6m 94 Series polypropylene channel - black	94P-60	62.00
2m 94 Series polypropylene channel with aluminium support - anodised finish	94PPA-A20	71.50
2.5m 94 Series polypropylene channel with aluminium support - anodised finish	94PPA-A25	91.50
3m 94 Series polypropylene channel with aluminium support - anodised finish	94PPA-A30	107.00
4m 94 Series polypropylene channel with aluminium support - anodised finish	94PPA-A40	131.00
5m 94 Series polypropylene channel with aluminium support - anodised finish	94PPA-A50	166.00
6m 94 Series polypropylene channel with aluminium support - anodised finish	94PPA-A60	195.00

# Brio Weatherfold 4s 150

For timber and aluminium doors - non-mortice

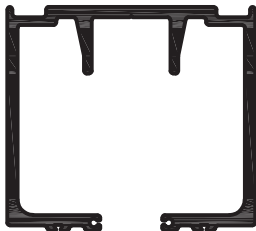

700  
87mm x 96mm



98PPA  
30mm x 25mm

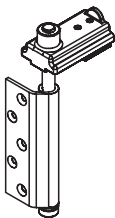

BWS1-150H



BW789H

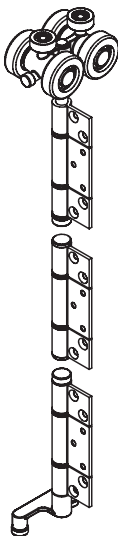

BWS4-150SH

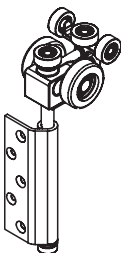

BWS2-150SH

Maximum leaf weight	150kg
Maximum leaf height	4m
Maximum leaf width	1.2m
Leaf thickness	44-68mm

## Tracks

Description	Code	Price
4m aluminium - anodised finish	700-CA40	1,980.00
6m aluminium - anodised finish	700-CA60	2,950.00

## Guide channels

Description	Code	Price
4m 98 Series polypropylene channel with aluminium support - anodised finish	98PPA-A40	443.00
6m 98 Series polypropylene channel with aluminium support - anodised finish	98PPA-A60	457.00

## Pivot set - non-mortice

Description	Code	Price
Sets consist of top and bottom pivots		
Pivot set - satin stainless steel	BWS1-150HSS	900.00

## Jam pivot

Description	Code	Price
Jamb pivot - satin stainless steel	BW789HSS	296.00

## End door hanger set - non-mortice

Description	Code	Price
Sets consist of top hanger and bottom guide		
End hanger - satin stainless steel	BWS2-150SHSS	1,070.00

## Intermediate door hanger set - non-mortice

Description	Code	Price
Sets consist of hanger, guide and one hinge		
Intermediate hanger - satin stainless steel	BWS4-150SHSS	1,520.00

## Joining rod

Description	Code	Price
Track jointing rod - pair	700TJR	44.00

## Hinge sets - non-mortice

Description	Code	Price
150 x 90 x 4mm stainless steel fixed pin ball bearing hinges		
Intermediate hinge set - two hinges with one hinge handle - satin stainless steel	BW3-150HSS	680.00
Intermediate hinge set - three hinges - satin stainless steel	BW5-150HSS	472.00
Offset hinge set - three hinges - satin stainless steel	BW6-150HSS	481.00
Offset hinge set - two hinges with one hinge handle - satin stainless steel	BW7-150HSS	690.00

## Single hinges - non-mortice

Description	Code	Price
150 x 90 x 4mm Stainless steel fixed pin ball bearing hinges		
150 x 90 x 4mm Intermediate hinge only - satin stainless steel	BW705HSS	157.00
150 x 90 x 4mm Offset hinge only - satin stainless steel	BW709HSS	161.00

# Brio Weatherfold 4s accessories



PS13B POLYPILE



AQ21 FRAMESEAL



AQ63

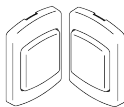

828

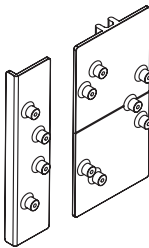

BW-DJH1

## Track, frame and perimeter seals

Description	Code	Price
13mm Track seal – 1m unit	PS13B/1	2.90
AQ21 frame seal – black – 1m unit	AQ21BL/1	7.80
AQ21 frame seal – white – 1m unit	AQ21W/1	7.80
AQ48 door seal – black – 1m unit	AQ48BL/1	7.80
AQ48 door seal – white – 1m unit	AQ48W/1	7.80
AQ63 door seal – black – 1m unit	AQ63BL/1	7.80
AQ63 door seal – white – 1m unit	AQ63W/1	7.80

## Magnetic catches

Description	Code	Price
Surface mounted magnetic catch (2 piece) – satin nickel	828SN	59.50
Surface mounted magnetic catch (2 piece) – black	828PBK	59.50

## Accessories

Description	Code	Price
Drilling jig for non-mortice hinges	BW-DJH1	11.50



# Brio Flush bolts



456

## 456 - Square top flush bolts

Description	Code	Price
190mm 456 Flush bolt – satin nickel	456SN	195.00
450mm 456 Flush bolt – satin nickel	456LSN	309.00
600mm 456 Flush bolt – satin nickel	456LXSN-600	665.00
190mm 456 Flush bolt – polished brass	456PVDB	224.00



456E

## 456E - Square top lockable flush bolt

Description	Code	Price
190mm 456 Lockable flush bolt – satin nickel	456ESN-1	274.00



456N

## 456N - Square top necked flush bolt

Description	Code	Price
190mm 456 Necked flush bolt – satin nickel	456NSN	243.00



456R

## 456R - Round top standard flush bolts

Description	Code	Price
190mm 456R Flush bolt – satin nickel	456RSN	195.00
450mm 456R Flush bolt – satin nickel	456RLSN	309.00
190mm 456R Flush bolt – polished brass	456RPVDB	224.00
450mm 456R Flush bolt – polished brass	456RLPVDB	353.00
190mm 456R Flush bolt – PVD black	456RPVDR	213.00



456RE

## 456RE - Round top lockable flush bolt

Description	Code	Price
190mm 456R Lockable flush bolt – satin nickel	456RESN-1	274.00



456RN

## 456RN - Round top necked flush bolt

Description	Code	Price
190mm 456R Necked flush bolt – satin nickel	456RNSN	243.00



360

## 360 - Flush bolts

Description	Code	Price
110mm 360 Flush bolt – satin nickel	360SN	121.00
300mm 360 Flush bolt – satin nickel	360LSN	222.00
110mm 360 Flush bolt – polished brass	360PVDB	121.00
300mm 360 Flush bolt – polished brass	360LPVDB	222.00



360E

## 360E - Lockable flush bolts

Description	Code	Price
110mm 360 Lockable flush bolt – satin nickel	360ESN-1	165.00
110mm 360 Lockable flush bolt – polished brass	360EPPVDB-1	165.00



360N

## 360N - Necked flush bolts

Description	Code	Price
110mm 360 Necked flush bolt – satin nickel	360NSN	146.00
110mm 360 Necked flush bolt – polished brass	360NPPVDB	146.00

## Flush bolt accessories



456 ROUTER

Description	Code	Price
Router bit for 456 flush bolt	ROUTER	337.00
Router bit for 360 flush bolt	ROUTER360	212.00
Replacement keeper for 360 and 456 flush bolts	456GRKS	35.00

All prices listed effective from 01/03/2022  
All prices listed exclude GST which is applied at the prevailing rate, currently 15%.

Indent items are indicated in red

# Brio 286 Dual Point Lock

Compatible with non-mortice Brio Weatherfold 4s, 50 and 100 door systems

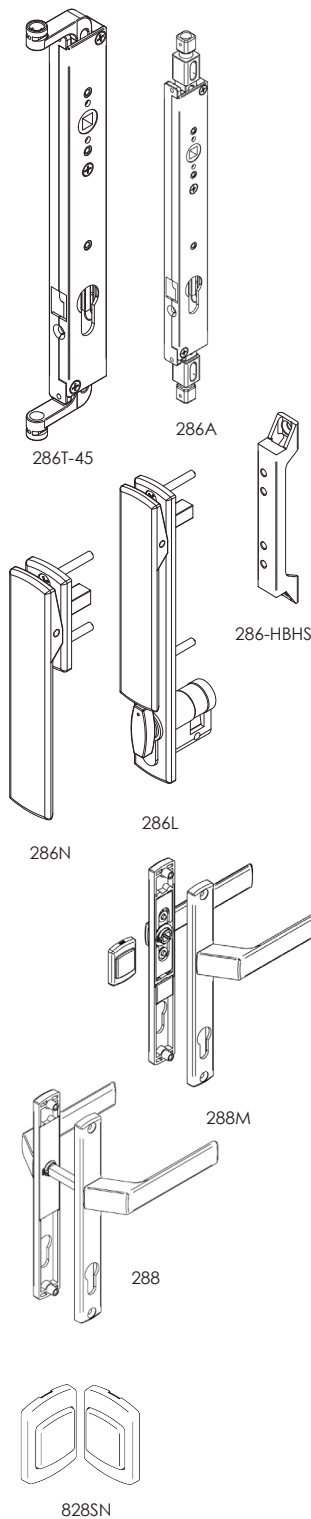

## Lock body

Description	Code	Price
286 Dual point lock body for timber doors, 35mm backset	286T-35	122.00
286 Dual point lock body for timber doors, 45mm backset	286T-45	122.00
286 Dual point lock body for aluminium doors	286A	102.00

## Rod kits

Description	Code	Price
<b>Kit consists of top and bottom rods, fixing cleats, hinge blocks (where necessary) and cover strip</b>		
Timber door intermediate panel rod kit for panel heights between 1.3m and 2.5m (includes three hinge blocks)	286-25HS	426.00
Timber door intermediate panel rod kit for panel heights between 2.5m and 3.5m (includes four hinge blocks)	286-35HS	499.00
Timber door end panel rod kit for panel heights between 1.3m and 2.5m	286-25XS	319.00
Timber door end panel rod kit for panel heights between 2.5m and 3.5m	286-35XS	354.00
Aluminium door rod kit for panel heights between 1.3m and 2.5m	286-25D	369.00
Aluminium door rod kit for panel heights between 2.5m and 3.5m	286-35D	441.00

## Bifold lock furniture

Description	Code	Price
286 bifold lock operator, non locking – satin stainless steel	286NSS	142.00
286 bifold lock operator, non locking – satin nickel	286NSN	95.00
286 bifold lock operator, non locking – black	286NPBK	83.00
286 bifold lock operator, locking with euro cylinder, two keys and short key – satin stainless steel	286L-40SS	177.00
286 bifold lock operator, locking with euro cylinder, two keys and short key – satin nickel	286L-40SN	131.00
286 bifold lock operator, locking with euro cylinder, two keys and short key – black	286L-40PBK	107.00

## Accessories

Description	Code	Price
Additional hinge block for 286-25HS or 286-35HS	286-HBHS	76.50

## Lever furniture

Description	Code	Price
<b>Furniture sets supplied with fixing screws and spindle, suitable for 44mm to 57mm door thickness</b>		
288 lever furniture set – satin stainless steel	288-85SS	190.00
288 lever furniture set – satin nickel	288-85SN	155.00
288 lever furniture set – satin black	288-85PBK	131.00
288M magnetic lever furniture set (low profile exterior, standard interior), inc. magnets – satin nickel	288M-85SN	179.00
288M magnetic lever furniture set (low profile exterior, standard interior), inc. magnets – black	288M-85PBK	155.00

## Magnetic catches

Description	Code	Price
Surface mounted magnetic catch (2 piece) – satin nickel	828SN	59.50
Surface mounted magnetic catch (2 piece) – black	828PBK	59.50

# Brio 612 Retractable insect screens

For single screens - select one screen kit and one corresponding frame kit  
For bi-parting screens - select two screen kits and two corresponding frame kits

## Screen kits - 1m high

	Pull bar colour			
Description	Black	White	Grey	Price
Consists of pleated insect screen, tensioning system and pull bar				
1m high x 1.1m wide black pleated screen	RSDL1.0-1.1PBK	RSDL1.0-1.1PWT	RSDL1.0-1.1PGY	900.00
1m high x 1.5m wide black pleated screen	RSDL1.0-1.5PBK	RSDL1.0-1.5PWT	RSDL1.0-1.5PGY	1,160.00
1m high x 2m wide black pleated screen	RSDL1.0-2.0PBK	RSDL1.0-2.0PWT	RSDL1.0-2.0PGY	1,310.00

## Screen kits - 1.2m high

	Pull bar colour			
Description	Black	White	Grey	Price
Consists of pleated insect screen, tensioning system and pull bar				
1.2m high x 1.1m wide black pleated screen	RSDL1.2-1.1PBK	RSDL1.2-1.1PWT	RSDL1.2-1.1PGY	945.00
1.2m high x 1.5m wide black pleated screen	RSDL1.2-1.5PBK	RSDL1.2-1.5PWT	RSDL1.2-1.5PGY	1,200.00
1.2m high x 2m wide black pleated screen	RSDL1.2-2.0PBK	RSDL1.2-2.0PWT	RSDL1.2-2.0PGY	1,360.00
1.2m high x 2.7m wide black pleated screen	RSDL1.2-2.7PBK	RSDL1.2-2.7PWT	RSDL1.2-2.7PGY	1,460.00

## Screen kits - 1.4m high

	Pull bar colour			
Description	Black	White	Grey	Price
Consists of pleated insect screen, tensioning system and pull bar				
1.4m high x 1.1m wide black pleated screen	RSDL1.4-1.1PBK	RSDL1.4-1.1PWT	RSDL1.4-1.1PGY	1,320.00
1.4m high x 1.5m wide black pleated screen	RSDL1.4-1.5PBK	RSDL1.4-1.5PWT	RSDL1.4-1.5PGY	1,740.00
1.4m high x 2m wide black pleated screen	RSDL1.4-2.0PBK	RSDL1.4-2.0PWT	RSDL1.4-2.0PGY	2,040.00
1.4m high x 2.7m wide black pleated screen	RSDL1.4-2.7PBK	RSDL1.4-2.7PWT	RSDL1.4-2.7PGY	2,320.00

## Screen kits - 1.6m high

	Pull bar colour			
Description	Black	White	Grey	Price
Consists of pleated insect screen, tensioning system and pull bar				
1.6m high x 1.1m wide black pleated screen	RSDL1.6-1.1PBK	RSDL1.6-1.1PWT	RSDL1.6-1.1PGY	1,440.00
1.6m high x 1.5m wide black pleated screen	RSDL1.6-1.5PBK	RSDL1.6-1.5PWT	RSDL1.6-1.5PGY	1,880.00
1.6m high x 2m wide black pleated screen	RSDL1.6-2.0PBK	RSDL1.6-2.0PWT	RSDL1.6-2.0PGY	2,170.00
1.6m high x 2.7m wide black pleated screen	RSDL1.6-2.7PBK	RSDL1.6-2.7PWT	RSDL1.6-2.7PGY	2,450.00
1.6m high x 3.6m wide black pleated screen	RSDL1.6-3.6PBK	RSDL1.6-3.6PWT	RSDL1.6-3.6PGY	2,990.00

## Frame kits - for screens 1m to 1.6m high

	Extrusion colour			
Description	Black	White	Grey	Price
Consists of head, sill and jamb extrusions				
Frame kit for screens up to 1.6m high x 1.5m wide	KIT-1-TPBK	KIT-1-TPWT	KIT-1-TPGY	260.00
Frame kit for screens up to 1.6m high x 2.2m wide	KIT-2-TPBK	KIT-2-TPWT	KIT-2-TPGY	365.00
Frame kit for screens up to 1.6m high x 3m wide	KIT-3-TPBK	KIT-3-TPWT	KIT-3-TPGY	469.00
Frame kit for screens up to 1.6m high x 4.5m wide	KIT-4-TPBK	KIT-4-TPWT	KIT-4-TPGY	680.00

### Single Screen

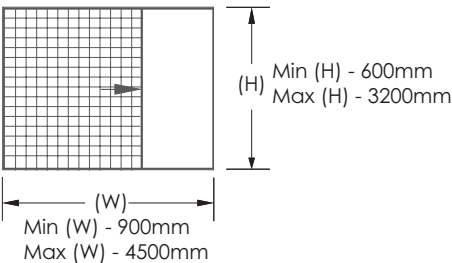

### Double Screen

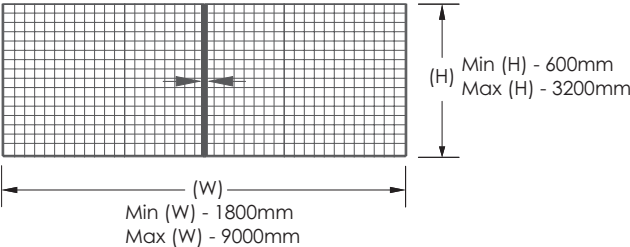

# Brio 612 Retractable insect screens

For single screens - select one screen kit and one corresponding frame kit

For bi-parting screens - select two screen kits and two corresponding frame kits

## Screen kits - 1.8m high

Description	Pull bar colour			Price
	Black	White	Grey	
Consists of pleated insect screen, tensioning system and pull bar				
1.8m high x 1.1m wide black pleated screen	RSDL1.8-1.1PBK	RSDL1.8-1.1PWT	RSDL1.8-1.1PGY	1,350.00
1.8m high x 1.5m wide black pleated screen	RSDL1.8-1.5PBK	RSDL1.8-1.5PWT	RSDL1.8-1.5PGY	1,730.00
1.8m high x 2m wide black pleated screen	RSDL1.8-2.0PBK	RSDL1.8-2.0PWT	RSDL1.8-2.0PGY	2,010.00
1.8m high x 2.7m wide black pleated screen	RSDL1.8-2.7PBK	RSDL1.8-2.7PWT	RSDL1.8-2.7PGY	2,270.00
1.8m high x 3.6m wide black pleated screen	RSDL1.8-3.6PBK	RSDL1.8-3.6PWT	RSDL1.8-3.6PGY	2,740.00

## Screen kits - 2m high

Description	Pull bar colour			Price
	Black	White	Grey	
Consists of pleated insect screen, tensioning system and pull bar				
2m high x 1.1m wide black pleated screen	RSDL2.0-1.1PBK	RSDL2.0-1.1PWT	RSDL2.0-1.1PGY	1,510.00
2m high x 1.5m wide black pleated screen	RSDL2.0-1.5PBK	RSDL2.0-1.5PWT	RSDL2.0-1.5PGY	1,910.00
2m high x 2m wide black pleated screen	RSDL2.0-2.0PBK	RSDL2.0-2.0PWT	RSDL2.0-2.0PGY	2,220.00
2m high x 2.7m wide black pleated screen	RSDL2.0-2.7PBK	RSDL2.0-2.7PWT	RSDL2.0-2.7PGY	2,510.00
2m high x 3.6m wide black pleated screen	RSDL2.0-3.6PBK	RSDL2.0-3.6PWT	RSDL2.0-3.6PGY	3,040.00
2m high x 4.5m wide black pleated screen	RSDL2.0-4.5PBK	RSDL2.0-4.5PWT	RSDL2.0-4.5PGY	3,600.00

## Screen kits - 2.2m high

Description	Pull bar colour			Price
	Black	White	Grey	
Consists of pleated insect screen, tensioning system and pull bar				
2.2m high x 1.1m wide black pleated screen	RSDL2.2-1.1PBK	RSDL2.2-1.1PWT	RSDL2.2-1.1PGY	1,530.00
2.2m high x 1.5m wide black pleated screen	RSDL2.2-1.5PBK	RSDL2.2-1.5PWT	RSDL2.2-1.5PGY	1,940.00
2.2m high x 2m wide black pleated screen	RSDL2.2-2.0PBK	RSDL2.2-2.0PWT	RSDL2.2-2.0PGY	2,240.00
2.2m high x 2.7m wide black pleated screen	RSDL2.2-2.7PBK	RSDL2.2-2.7PWT	RSDL2.2-2.7PGY	2,530.00
2.2m high x 3.6m wide black pleated screen	RSDL2.2-3.6PBK	RSDL2.2-3.6PWT	RSDL2.2-3.6PGY	3,070.00
2.2m high x 4.5m wide black pleated screen	RSDL2.2-4.5PBK	RSDL2.2-4.5PWT	RSDL2.2-4.5PGY	3,620.00

## Screen kits - 2.4m high

	Pull bar colour			
Description	Black	White	Grey	Price
Consists of pleated insect screen, tensioning system and pull bar				
2.4m high x 1.1m wide black pleated screen	RSDL2.4-1.1PBK	RSDL2.4-1.1PWT	RSDL2.4-1.1PGY	1,550.00
2.4m high x 1.5m wide black pleated screen	RSDL2.4-1.5PBK	RSDL2.4-1.5PWT	RSDL2.4-1.5PGY	1,970.00
2.4m high x 2m wide black pleated screen	RSDL2.4-2.0PBK	RSDL2.4-2.0PWT	RSDL2.4-2.0PGY	2,260.00
2.4m high x 2.7m wide black pleated screen	RSDL2.4-2.7PBK	RSDL2.4-2.7PWT	RSDL2.4-2.7PGY	2,560.00
2.4m high x 3.6m wide black pleated screen	RSDL2.4-3.6PBK	RSDL2.4-3.6PWT	RSDL2.4-3.6PGY	3,090.00
2.4m high x 4.5m wide black pleated screen	RSDL2.4-4.5PBK	RSDL2.4-4.5PWT	RSDL2.4-4.5PGY	3,640.00

## Frame kits - for screens 1.8m to 2.4m high

Description	Extrusion colour			Price
	Black	White	Grey	
Consists of head, sill and jamb extrusions				
Frame kit for screens up to 2.4m high x 1.5m wide	KIT-5-TPBK	KIT-5-TPWT	KIT-5-TPGY	292.00
Frame kit for screens up to 2.4m high x 2.2m wide	KIT-6-TPBK	KIT-6-TPWT	KIT-6-TPGY	388.00
Frame kit for screens up to 2.4m high x 3m wide	KIT-7-TPBK	KIT-7-TPWT	KIT-7-TPGY	500.00
Frame kit for screens up to 2.4m high x 4.5m wide	KIT-8-TPBK	KIT-8-TPWT	KIT-8-TPGY	700.00

### Single Screen

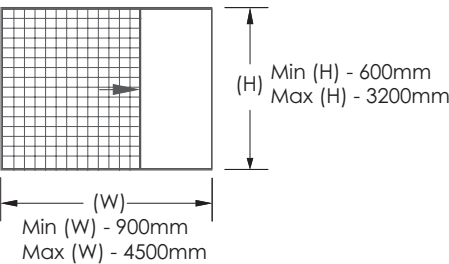

### Double Screen

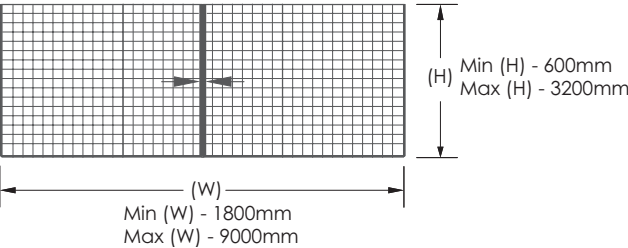

# Brio 612 Retractable insect screens

For single screens - select one screen kit and one corresponding frame kit  
For bi-parting screens - select two screen kits and two corresponding frame kits

## Screen kits - 2.6m high

	Pull bar colour			
Description	Black	White	Grey	Price
Consists of pleated insect screen, tensioning system and pull bar				
2.6m high x 1.1m wide black pleated screen	RSDL2.6-1.1PBK	RSDL2.6-1.1PWT	RSDL2.6-1.1PGY	1,690.00
2.6m high x 1.5m wide black pleated screen	RSDL2.6-1.5PBK	RSDL2.6-1.5PWT	RSDL2.6-1.5PGY	2,150.00
2.6m high x 2m wide black pleated screen	RSDL2.6-2.0PBK	RSDL2.6-2.0PWT	RSDL2.6-2.0PGY	2,480.00
2.6m high x 2.7m wide black pleated screen	RSDL2.6-2.7PBK	RSDL2.6-2.7PWT	RSDL2.6-2.7PGY	2,820.00
2.6m high x 3.6m wide black pleated screen	RSDL2.6-3.6PBK	RSDL2.6-3.6PWT	RSDL2.6-3.6PGY	3,430.00
2.6m high x 4.5m wide black pleated screen	RSDL2.6-4.5PBK	RSDL2.6-4.5PWT	RSDL2.6-4.5PGY	4,050.00

## Screen kits - 2.8m high

	Pull bar colour			
Description	Black	White	Grey	Price
Consists of pleated insect screen, tensioning system and pull bar				
2.8m high x 1.1m wide black pleated screen	RSDL2.8-1.1PBK	RSDL2.8-1.1PWT	RSDL2.8-1.1PGY	1,780.00
2.8m high x 1.5m wide black pleated screen	RSDL2.8-1.5PBK	RSDL2.8-1.5PWT	RSDL2.8-1.5PGY	2,240.00
2.8m high x 2m wide black pleated screen	RSDL2.8-2.0PBK	RSDL2.8-2.0PWT	RSDL2.8-2.0PGY	2,590.00
2.8m high x 2.7m wide black pleated screen	RSDL2.8-2.7PBK	RSDL2.8-2.7PWT	RSDL2.8-2.7PGY	2,950.00
2.8m high x 3.6m wide black pleated screen	RSDL2.8-3.6PBK	RSDL2.8-3.6PWT	RSDL2.8-3.6PGY	3,590.00
2.8m high x 4.5m wide black pleated screen	RSDL2.8-4.5PBK	RSDL2.8-4.5PWT	RSDL2.8-4.5PGY	4,210.00

## Screen kits - 3m high

	Pull bar colour			
Description	Black	White	Grey	Price
Consists of pleated insect screen, tensioning system and pull bar				
3m high x 1.1m wide black pleated screen	RSDL3.0-1.1PBK	RSDL3.0-1.1PWT	RSDL3.0-1.1PGY	1,850.00
3m high x 1.5m wide black pleated screen	RSDL3.0-1.5PBK	RSDL3.0-1.5PWT	RSDL3.0-1.5PGY	2,320.00
3m high x 2m wide black pleated screen	RSDL3.0-2.0PBK	RSDL3.0-2.0PWT	RSDL3.0-2.0PGY	2,680.00
3m high x 2.7m wide black pleated screen	RSDL3.0-2.7PBK	RSDL3.0-2.7PWT	RSDL3.0-2.7PGY	3,040.00
3m high x 3.6m wide black pleated screen	RSDL3.0-3.6PBK	RSDL3.0-3.6PWT	RSDL3.0-3.6PGY	3,700.00
3m high x 4.5m wide black pleated screen	RSDL3.0-4.5PBK	RSDL3.0-4.5PWT	RSDL3.0-4.5PGY	4,360.00

## Screen kits - 3.2m high

	Pull bar colour			
Description	Black	White	Grey	Price
Consists of pleated insect screen, tensioning system and pull bar				
3.2m high x 1.1m wide black pleated screen	RSDL3.2-1.1PBK	RSDL3.2-1.1PWT	RSDL3.2-1.1PGY	1,910.00
3.2m high x 1.5m wide black pleated screen	RSDL3.2-1.5PBK	RSDL3.2-1.5PWT	RSDL3.2-1.5PGY	2,410.00
3.2m high x 2m wide black pleated screen	RSDL3.2-2.0PBK	RSDL3.2-2.0PWT	RSDL3.2-2.0PGY	2,770.00
3.2m high x 2.7m wide black pleated screen	RSDL3.2-2.7PBK	RSDL3.2-2.7PWT	RSDL3.2-2.7PGY	3,170.00
3.2m high x 3.6m wide black pleated screen	RSDL3.2-3.6PBK	RSDL3.2-3.6PWT	RSDL3.2-3.6PGY	3,840.00
3.2m high x 4.5m wide black pleated screen	RSDL3.2-4.5PBK	RSDL3.2-4.5PWT	RSDL3.2-4.5PGY	4,530.00

## Frame kits - for screens 2.6m to 3.2m high

Description	Extrusion colour			Price
	Black	White	Grey	
Consists of head, sill and jamb extrusions				
Frame kit for screens up to 3.2m high x 1.5m wide	KIT-9-TPBK	KIT-9-TPWT	KIT-9-TPGY	321.00
Frame kit for screens up to 3.2m high x 2.2m wide	KIT-10-TPBK	KIT-10-TPWT	KIT-10-TPGY	419.00
Frame kit for screens up to 3.2m high x 3m wide	KIT-11-TPBK	KIT-11-TPWT	KIT-11-TPGY	525.00
Frame kit for screens up to 3.2m high x 4.5m wide	KIT-12-TPBK	KIT-12-TPWT	KIT-12-TPGY	720.00

### Single Screen

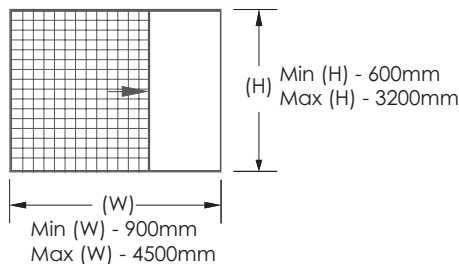

### Double Screen

